

EASY ASSEMBLY AND OPERATION INSTRUCTIONS

MR-125056 Whimsical Scarecrow



Please follow the step by step guide and enjoy your Whimsical Scarecrow!

Please read all instructions carefully before assembling. Save this instruction sheet for future reference.

CARE AND STORAGE INSTRUCTIONS

For best performance operate your item indoors. When not in use, store this product in its original packing. Keep away from heat and moisture.

⚠ WARNING

This item is not a toy and should be used for decoration only. This item contains small parts that can be a choking hazard. Keep all plastic and wire parts away from children.

1. Please use the adapter supplied by manufacturer.
2. Please assemble item according to instructions. Connect all wires according to matching color.
3. Children should be supervised by adults. Item should not be grabbed, as it becomes a tipping hazard.
4. Keep all away from the adapter, as it heats up during operation.

PARTS LIST

- A. Base x 1
 - B. Left Pole x 1
 - C. Right Poles x 2
 - D. Left Knee Pole x 1
 - E. Boots x 2
 - F. Foam Tubes x 2
 - G. Costume x 1
 - H. Body Frame x 1
 - I. Left Arm x 1
 - J. Right Arm x 1
 - K. Crow x 1
 - L. Head x 1
 - M. Hat x 1
 - N. Step Here Pad x 1
 - O. Universal Adapter (Included) x 1
- Input: 100 - 240VAC 50/60Hz
Output: 5.9V 3.0A



BEFORE ASSEMBLING, REMOVE ALL THE ABOVE PARTS FROM BOX. IF ANY PART IS MISSING, PLEASE CONTACT CUSTOMER SERVICE AT SUPPORT@MORRIS COSTUMES.COM, OR BY PHONE 704-332-3304. IN YOUR EMAIL INQUIRY, PLEASE INCLUDE: YOUR ORDER NUMBER, WHO YOU BOUGHT IT FROM, AND WHAT SPECIFICALLY IS WRONG. THANK YOU.

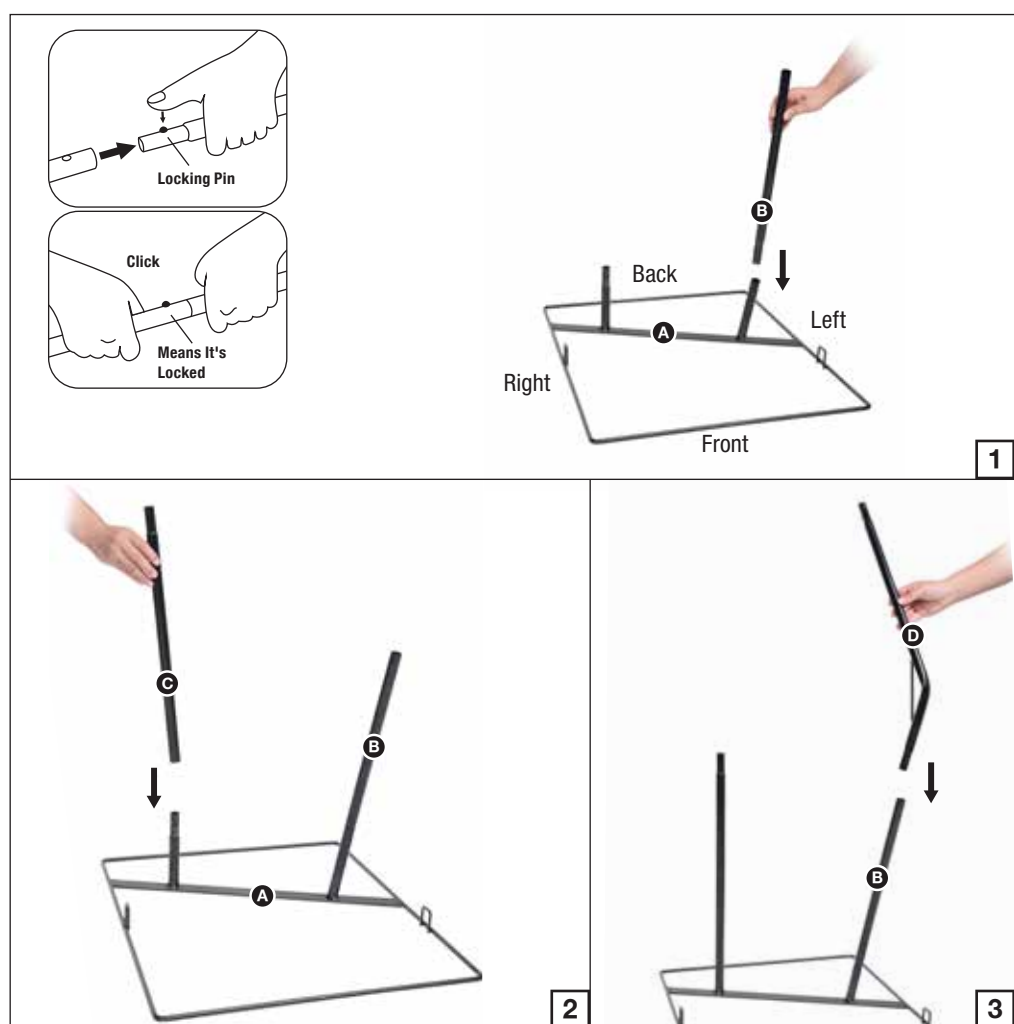

STEP 1

Note: Throughout the instructions, Left and Right are from the character's point of view.
Attach the (B) Left Pole to the left side of the (A) Base using the available quick connect push button and pre-drilled hole as shown in Figure 1. Attach one of the (C) Right Poles to the right side of the (A) Base using the available quick connect push button and pre-drilled hole as shown in Figure 2. Then attach the (D) Left Knee Pole to the (B) Left Pole using the available quick connect push button and pre-drilled hole as shown in Figure 3.



STEP 2

Attach the remaining (C) Right Pole to the previously assembled (C) Right Pole using the available quick connect push button and pre-drilled hole as shown in Figure 1. Then slide the (E) Boots over the (B, D) Left Poles and the (C) Right Poles and place the (E) Boots over the pegs on the (A) Base as shown in Figure 2. Slide the (F) Foam Tubes over the (B, D) Left Poles and the (C) Right Poles as shown in Figure 3. Slip the pant legs of the (G) Costume over each (F) Foam Tube, the opening of the (G) Costume should be aiming towards the back as shown in Figure 4.



OPTIONAL:
If you choose to use the Step Activation Pad, plug the connector into the input receiving jack marked "TRY ME" on the Function Control Box and set the Step pad in front of the character when ready to display.
Note: Do not plug the Power Adapter into power outlet until item assembly is completed.

STEP 3
Attach the (H) Body Frame to the (C) Right Pole and (D) Left Knee Pole using the available quick connect push buttons and pre-drilled holes as shown in Figure 1. Now, plug the Adapter into the input receiving jack marked "DC 5.9V" on the Function Control Box and route the Power Adapter down and out the bottom of the item as shown in Figure 2.

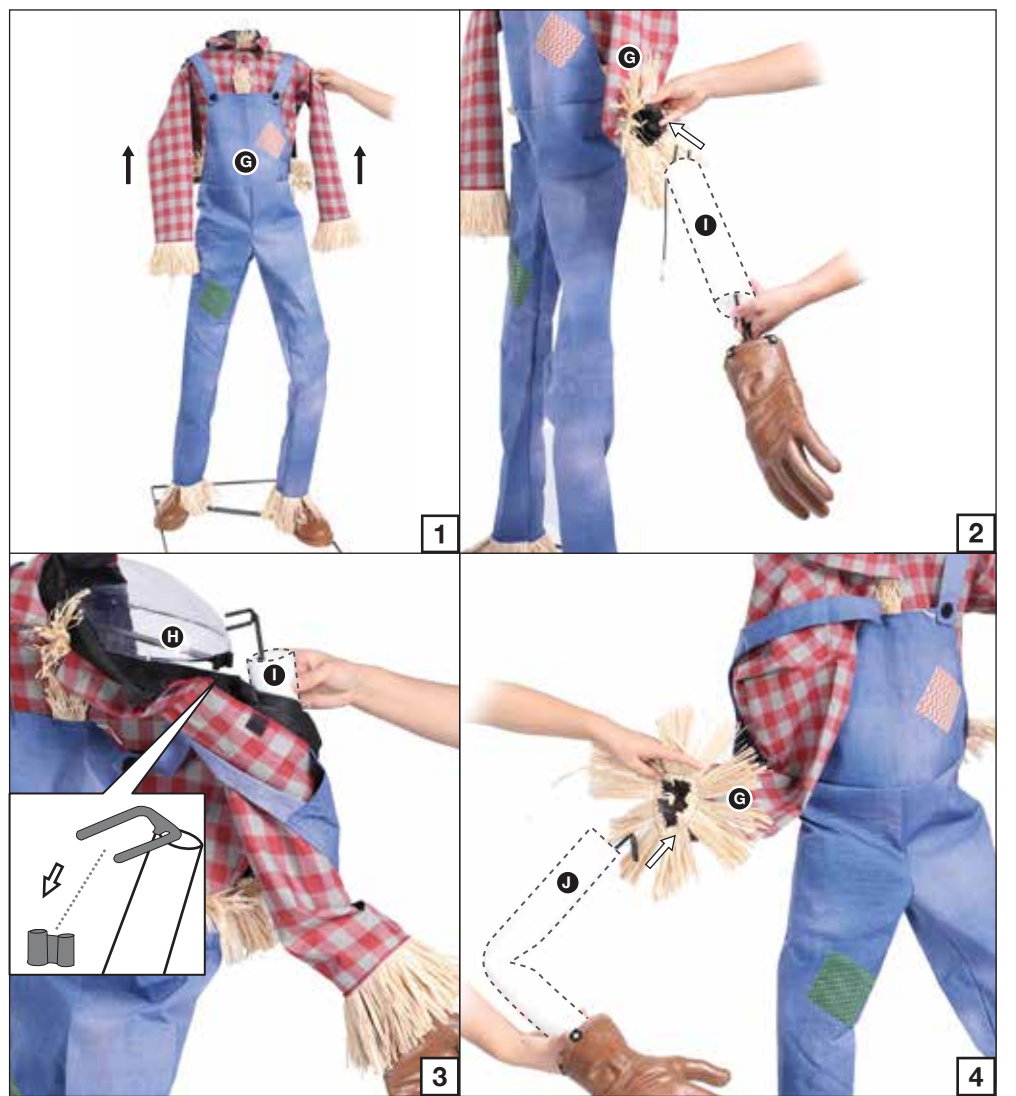

STEP 4
Bring the (G) Costume up over the top of the (H) Body Frame as shown in Figure 1. Slide the (I) Left Arm up into the left sleeve of the (G) Costume as shown in Figure 2. Then set the forked hook of the (I) Left Arm into the housing available on the left side of the (H) Body Frame. Slide the (J) Right Arm up the right sleeve of the (G) Costume as shown in Figure 4.

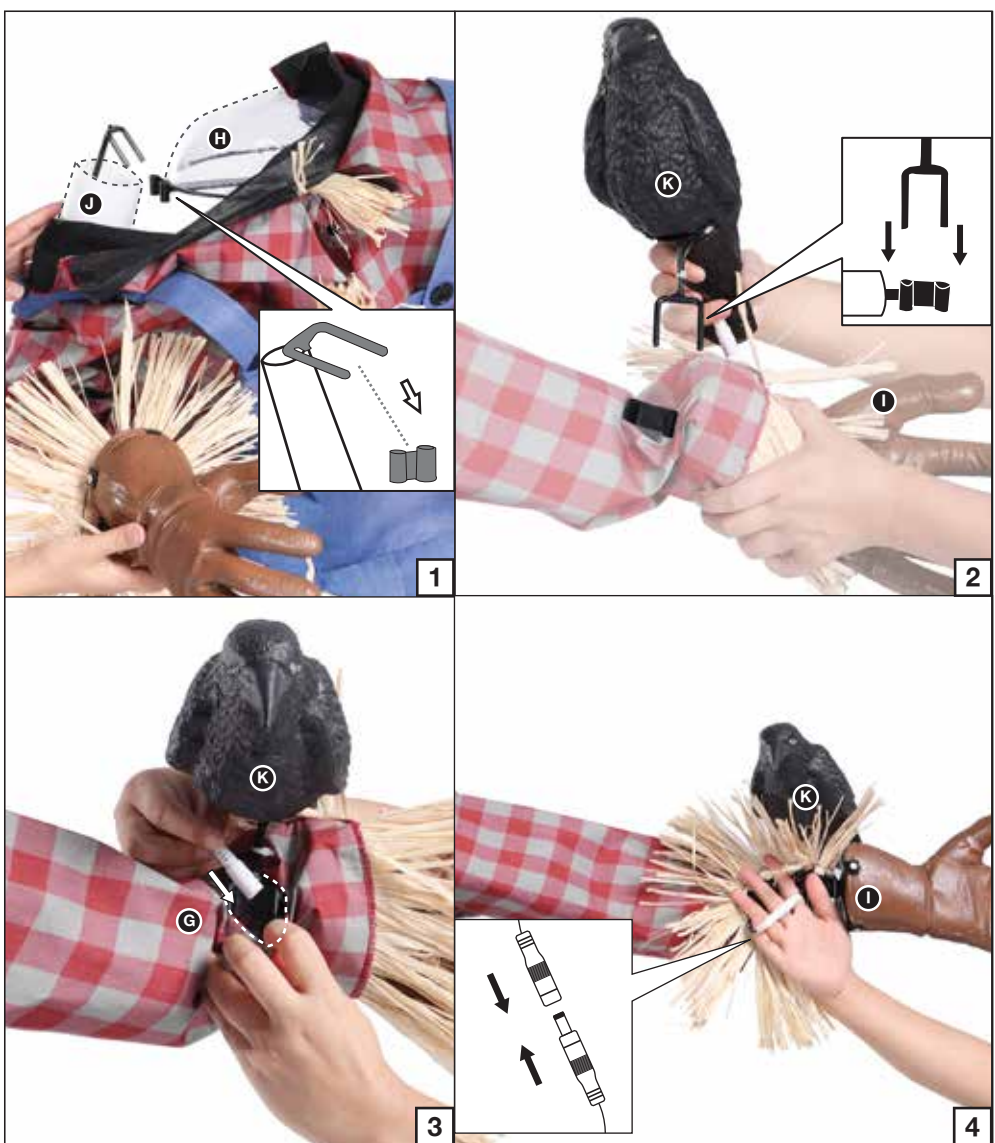

STEP 5
Set the forked hook of the (J) Right Arm into the housing on the right side of the (H) Body Frame as shown in Figure 1. Set the forked hook of the (K) Crow through the hole in the (G) Costume and into the housing available on the (I) Left Arm as shown in Figure 2. Insert the cable from the (K) Crow into the hole available in the sleeve of the (G) Costume as shown in Figure 3. Then attach the cable from the (K) Crow to its corresponding cable available from the (I) Left Arm as shown in Figure 4.



STEP 6
Set the forked hook of the (L) Head into the housing available at the top of the (H) Body Frame as shown in Figure 1. Then connect all cables from the Function Control Box to their corresponding cables by color and shape as shown in Figure 2. Attach the Sensor to the hole at the front of the (G) Costume from the inside using the available hook and loop closure as shown in Figure 3. Close the back of the (G) Costume using the available hook and loop closures as shown in Figure 4.



STEP 7
 Attach the (M) Hat to the (L) Head using the available hook and loop closures as shown in Figures 1 and 2.
 Your Whimsical Scarecrow is now fully assembled. Plug in and turn on to let the fun begin!

OPERATION INSTRUCTIONS:

1. Plug the power adapter into a standard power outlet and adjust the settings on the Function Control Box, located on the (H) Body Frame , as desired.

2. Settings:

Sensor /Détecteur	This switch mode will activate lights, sound, and animation when the Infra-red (IR) sensor is activated and will operate for 1 audio-cycle with each activation. The Infra-red (IR) sensor has a range of up to 2 m/6.5 ft. and will activate when someone comes within an 80-degree angle from left-to-right, as well as from above and below.
○	This switch mode allows the item to be activated only if triggered by using a Step Here Try Me Activation Pad (Included). The item will operate for one audio cycle with each Try Me activation.
	This switch mode will continually operate the lights, sound, and animation of the item.
⊖ ⊕	Raise or lower the volume using the volume control turn dial, turn all the way down to turn the volume off .

This device complies with Part 15 of the FCC Rules. Operation is subject to the following two conditions: (1) This device may not cause harmful interference, and (2) this device must accept any interference received, including interference that may cause undesired operation.

CAUTION: Changes or modifications not expressly approved by the party responsible for compliance could void the user's authority to operate the equipment.

NOTE: This equipment has been tested and found to comply with the limits for a Class B digital device, pursuant to Part 15 of the FCC Rules. These limits are designed to provide reasonable protection against harmful interference in a residential installation. This equipment generates, uses and can radiate radio frequency energy and, if not installed and used in accordance with the instructions, may cause harmful interference to radio communications. However, there is no guarantee that interference will not occur in a particular installation. If this equipment does cause harmful interference to radio or television reception, which can be determined by turning the equipment off and on, the user is encouraged to try to correct the interference by one or more of the following measures: Reorient or relocate the receiving antenna, Increase the separation between the equipment and receiver, Connect the equipment into an outlet on a circuit different from that to which the receiver is connected. Consult the dealer or experienced radio/TV technician for help.

