

RISING GHOST™

INSTALLATION AND OPERATING INSTRUCTIONS

KEEP ALL PLASTIC AND WIRE PARTS AWAY FROM CHILDREN

WARNING: DO NOT TURN ON THE PROP UNTIL FULLY ASSEMBLED: STAY CLEAR OF THE PROP WHILE OPERATING

PARTS:

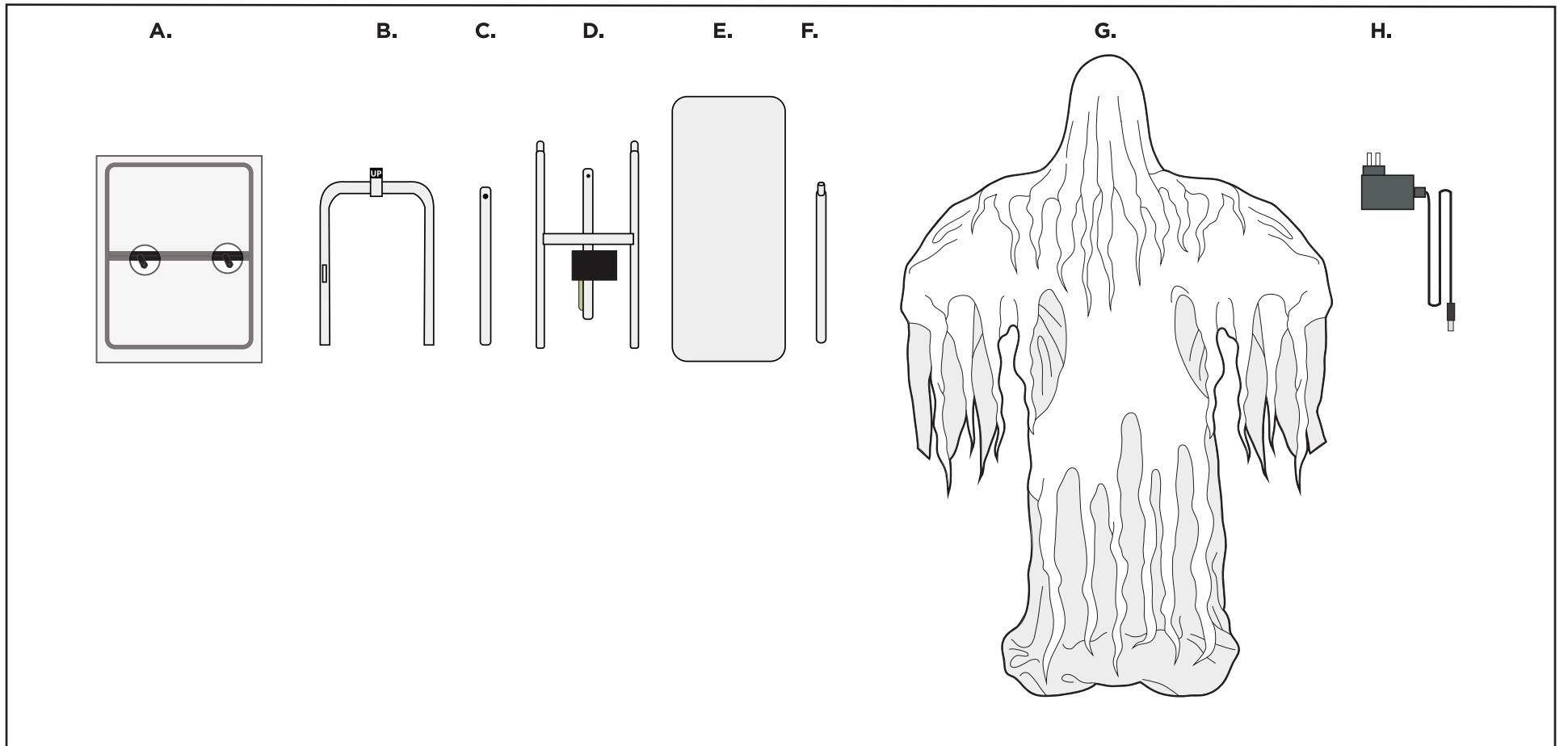

A. Metal Base
B. Upper Frame

C. Upper Frame Pole
D. Lower Frame and Module

E. Fabric Frame Cover
F. Center Body Pole

G. Ghost Body
H. Adapter

ASSEMBLY

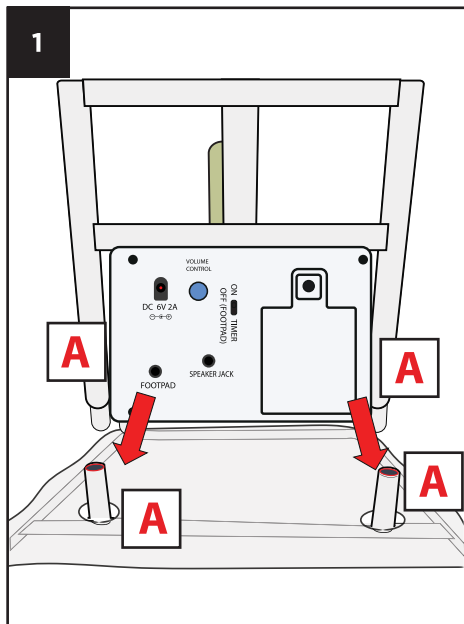

1 Snap lock LOWER FRAME AND MODULE onto METAL BASE. (Match A to A)

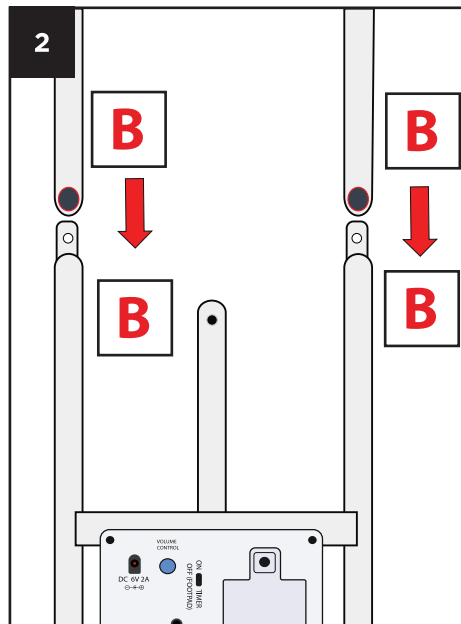

2 Snap lock UPPER FRAME onto LOWER FRAME AND MODULE. (Match B to B)

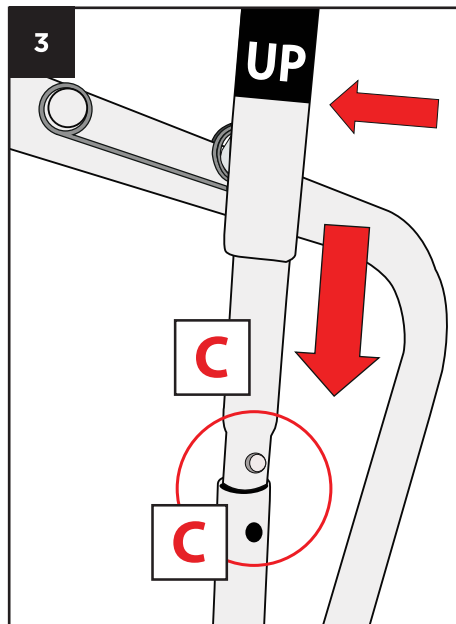

3 Slide the UPPER FRAME POLE through the sleeve marked UP on the UPPER FRAME. Snap lock the UPPER FRAME POLE into the LOWER FRAME AND MODULE. (Match C to C)

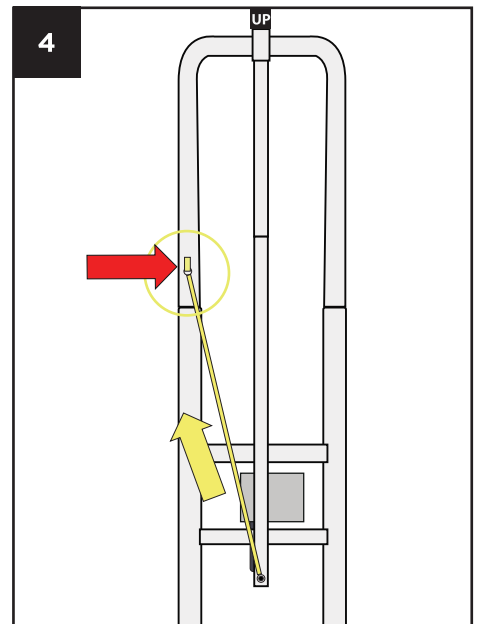

4 Attach the spring located on the LOWER FRAME AND MODULE to the hook on the UPPER FRAME AND CENTER POLE. (Match YELLOW TO YELLOW)

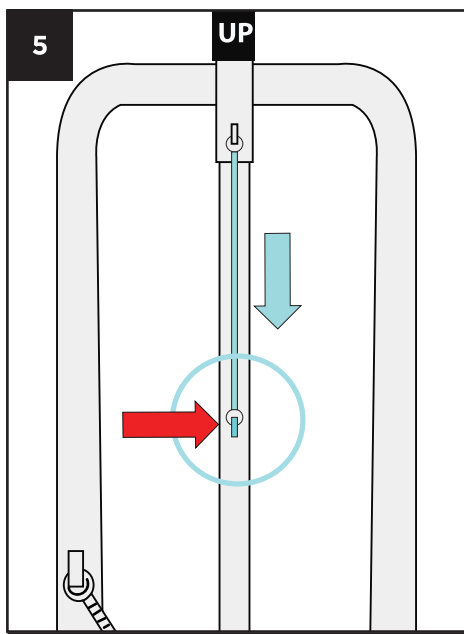

Attach the spring located on the UPPER FRAME AND CENTER POLE to the hook on the CENTER POLE.
(Match BLUE TO BLUE)

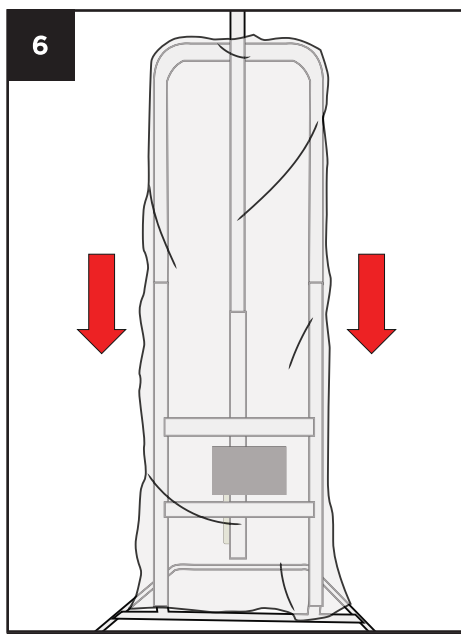

Slide the FABRIC FRAME COVER over the assembled UPPER FRAME AND CENTER POLE.

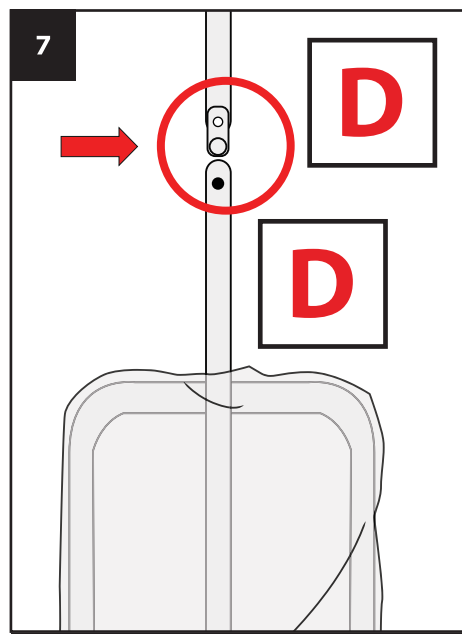

Snap lock the CENTER BODY POLE onto the UPPER FRAME POLE.
(Match D to D)

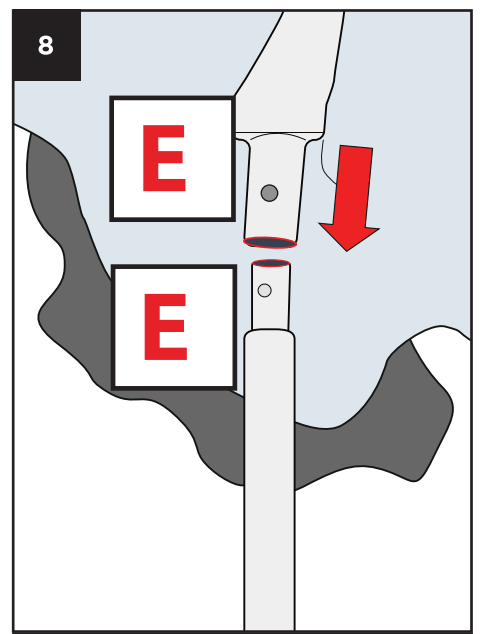

Snap lock the GHOST BODY POLE onto the UPPER FRAME POLE.
(Match E to E)

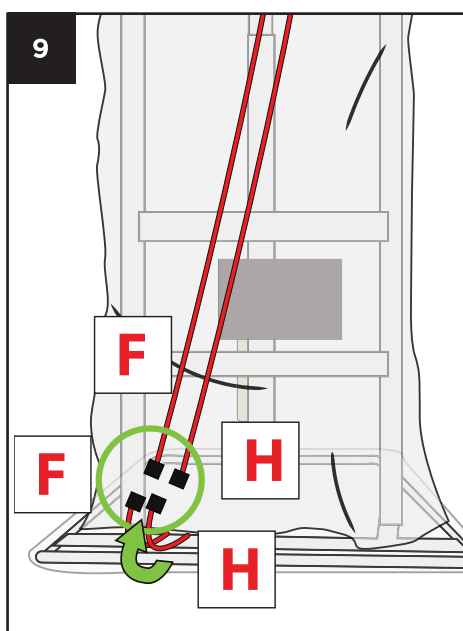

Reach inside the GHOST BODY FABRIC and connect the wires labeled H and F from the MODULE to the wires running outside the FABRIC FRAME COVER. Make sure the wires stay on the outside of the FABRIC FRAME COVER to prevent damage.
(Connect H to H)
(Connect F to F)

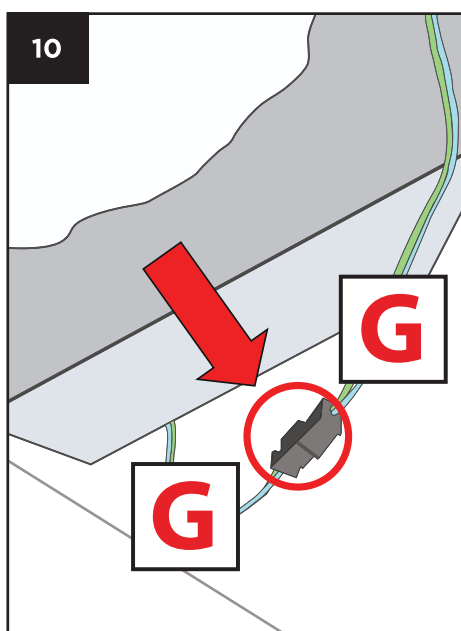

Connect the wire labeled G LOCATED UNDER THE FABRIC FRAME COVER.
(Connect G to G)

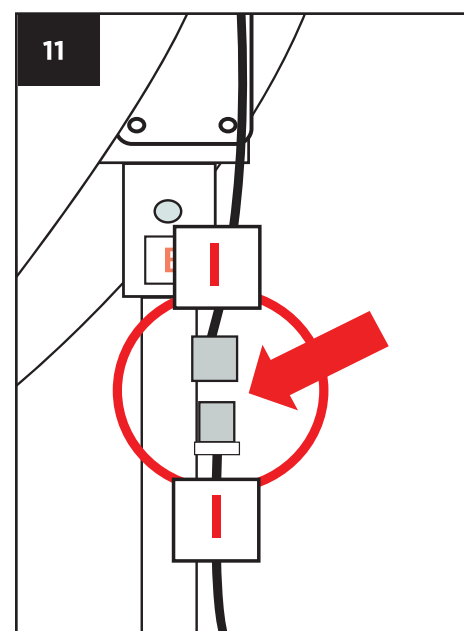

Connect the wire labeled I LOCATED UNDER THE FABRIC FRAME COVER.
(Connect I to I)

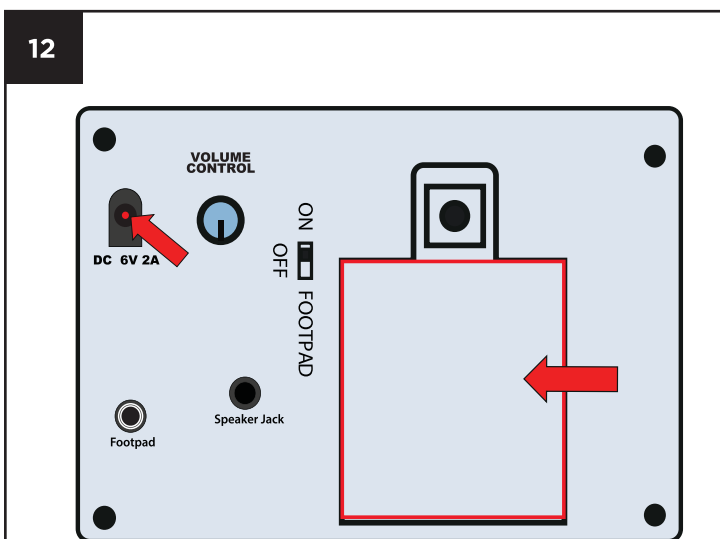

Reach inside the FABRIC FRAME COVER and connect 6V 2A ADAPTER (included) or insert 4 AA alkaline batteries (not included) into the battery compartment located on the MODULE. Turn switch to the ON position and make a loud sound or clap to activate item.

Turn switch on MODULE to TIMER to operate in Timer/Sound mode. W.Raith will function with 5 minute breaks between cycles - or, clap during 5 minute break to instantly start playing again. Leave switch in the OFF position when not in use.

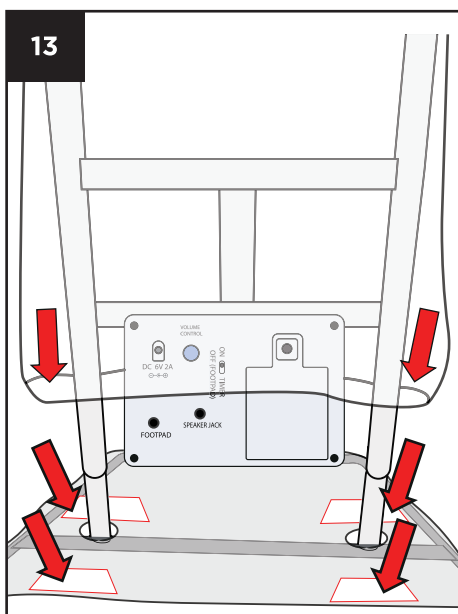

Attach the four hook and loop fasteners on the FABRIC FRAME COVER to the hook and loop fasteners on the METAL BASE.

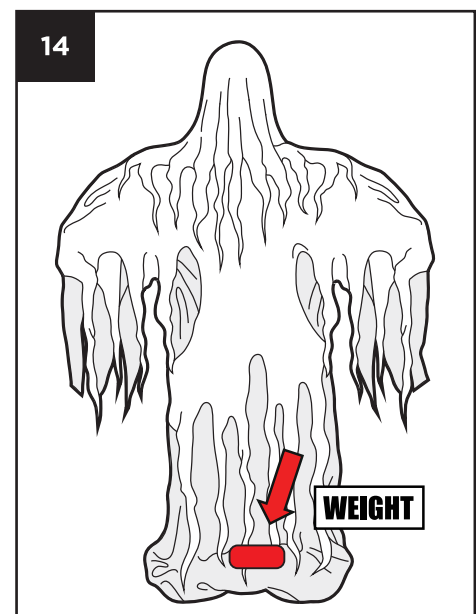

Position item as shown and place weight if necessary.

OPTIONAL EXTERNAL SPEAKER SET UP

EXTERNAL SPEAKER IS NOT INCLUDED. MUST BE PURCHASED SEPARATELY.

1. Plug speaker cord into the jack labeled SPEAKER JACK located on the CONTROL BOX.
2. Use volume knob on external speaker to control volume levels.

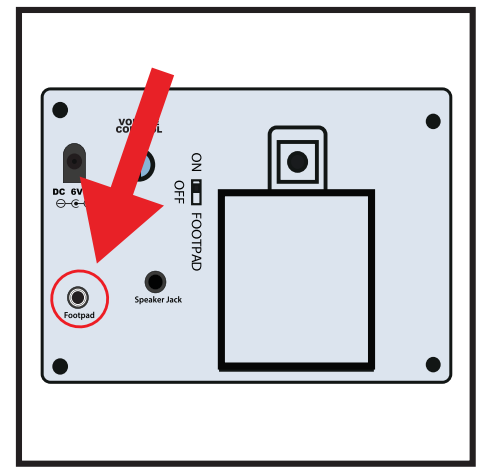

OPTIONAL FOOTPAD SET UP

FOOTPAD IS NOT INCLUDED. MUST BE PURCHASED SEPARATELY.

1. Insert the cable from FOOTPAD into the jack labeled FOOTPAD on the CONTROL BOX.
2. Place the switch in the FOOTPAD position to enable FOOTPAD activation.
3. Step on the FOOTPAD to activate the scary sequence!
 - * Footpads are sold separately and can be purchased at www.tekkyaccessories.com

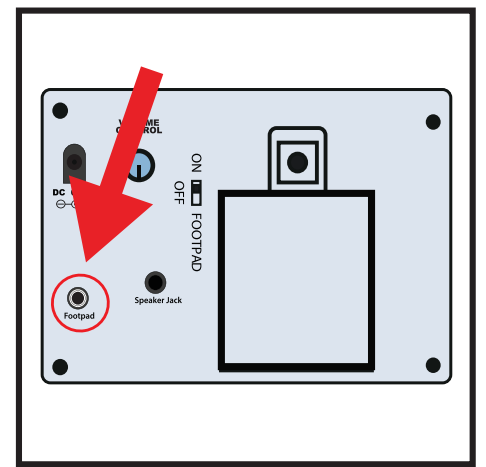

Battery Diagram

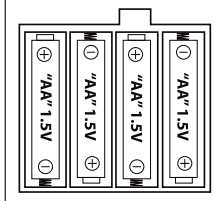

BATTERY INSTRUCTIONS AND CAUTIONS

Battery installation and removal should be performed by an adult. Remove batteries when not in use. Use only batteries recommended in the instructions. Do not mix new and used batteries. Do not mix alkaline, carbon-zinc, nickel-cadmium, rechargeable or different types of batteries. Be mindful to insert batteries with the correct polarity (+/-) as indicated. Remove all exhausted batteries. Rechargeable batteries are only to be charged under adult supervision. Rechargeable batteries are to be removed from the item before being charged. Non-rechargeable batteries are not to be recharged. The supply terminals are not to be short-circuited. Always dispose of exhausted batteries properly. Do NOT dispose of batteries in fire, they may leak or explode.

Warning! This item is not a toy. For decoration only. Small parts, choking hazard. This product is intended for use by persons 15 years of age and older. Not intended for use by children ages 14 years and younger.

WARNING

DO NOT TURN ITEM ON UNTIL YOU HAVE COMPLETELY FINISHED ASSEMBLY. STAY CLEAR OF ITEM WHILE OPERATING. DO NOT PLACE ITEM ON UNEVEN GROUND. DO NOT PLACE WEIGHT ON ITEM WHILE IN OPERATION.



TEKKY

visit us at tekkydesign.com

Requires 6V 2A ADAPTER (included) or 4 AA batteries (not included)

ALL NEW MATERIALS:
METAL, FOAM, PLASTIC, POLYESTER
Surface washable only.

RISING GHOST™ is a trademark of Tekky.
Copyright © 2023 Tekky.
All Rights Reserved.
MADE IN CHINA



DO NOT RETURN THIS ITEM TO THE STORE!
If experiencing technical difficulties, please go to www.tekkydesign.com for assistance.