

ANIMATED GHOST WITCH™

Installation and Operating Instructions

Keep all plastic and wire parts away from children.

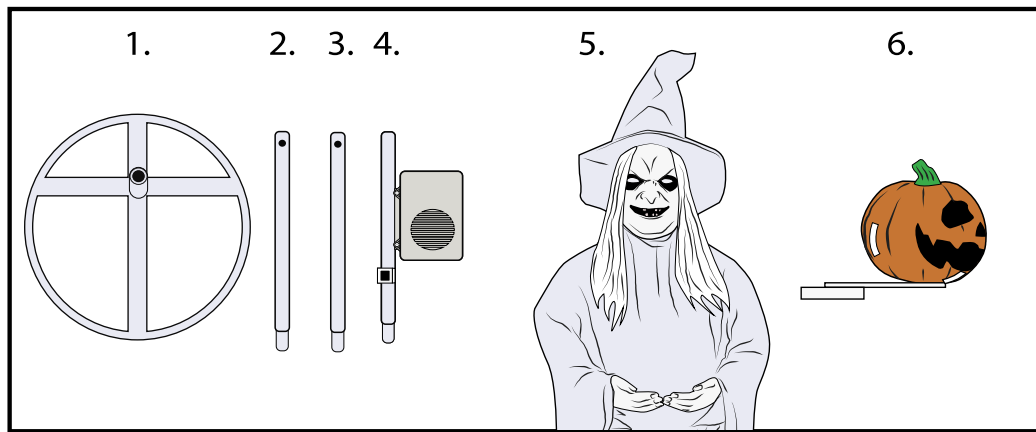

PARTS

1. METAL BASE
2. LOWER POLE
3. MIDDLE POLE
4. UPPER POLE AND MODULE
5. HEAD BODY AND HANDS
6. PUMPKIN

1. Snap lock LOWER POLE onto METAL BASE. (MATCH A to A)
2. Snap lock MIDDLE POLE onto LOWER POLE. (Match B to B)
3. Snap lock UPPER POLE AND MODULE onto MIDDLE POLE. (Match C to C)
4. Snap lock HEAD BODY AND HANDS onto UPPER POLE AND MODULE. (Match D to D)
5. Locate the hole above the hands in the fabric. Insert the PUMPKIN bracket and wire marked F through the hole in fabric and snap lock the PUMPKIN bracket to the UPPER POLE AND MODULE. (Match E to E)
6. Locate the three wires underneath the fabric of the HEAD BODY AND HANDS. Connect the three wires. (Connect F to F) (Connect G to G) (Connect H to H)
7. Reach inside the fabric on the HEAD BODY AND HANDS and connect 6V 2A ADAPTER (not included) or insert 4 AA alkaline batteries (not included) into the battery compartment located on the UPPER POLE AND MODULE. Turn switch to ON position and move in front of the item or make a loud sound (clap) to activate item.
8. Locate the hook and loop fasteners on both HANDS. Attach the hook and loop fasteners on the hands to the hook and loop fasteners on the PUMPKIN.
9. Attach the hook and loop fasteners located on the fabric to the hook and loop fasteners on the METAL FRAME.
10. Position item as shown and add weight if necessary.

NOTE: FOR USE IN WIND - PLACE WEIGHT ON METAL BASE FOR EXTRA STABILITY AS NEEDED.

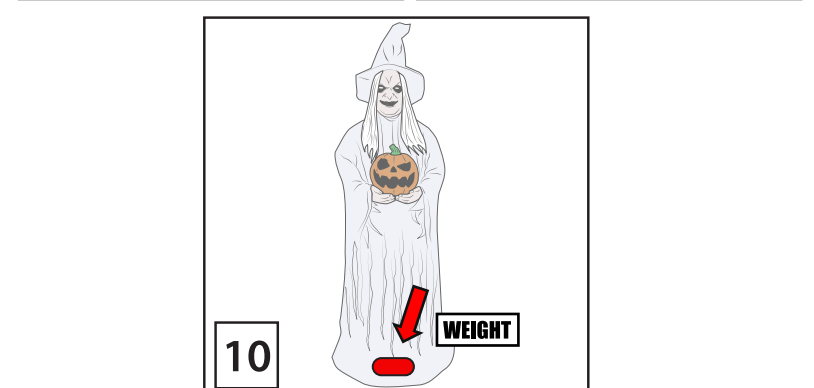
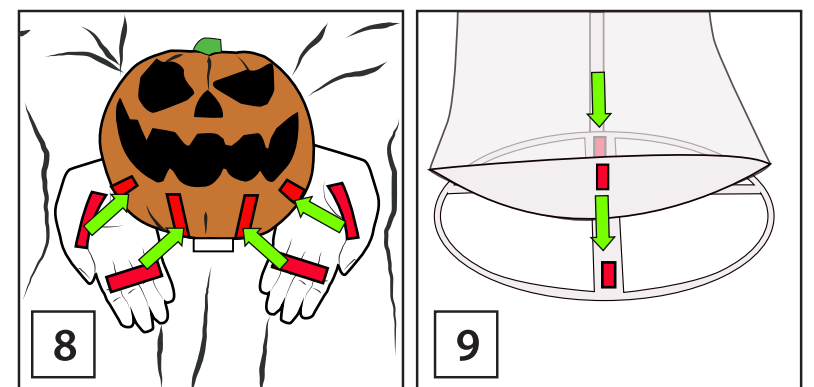
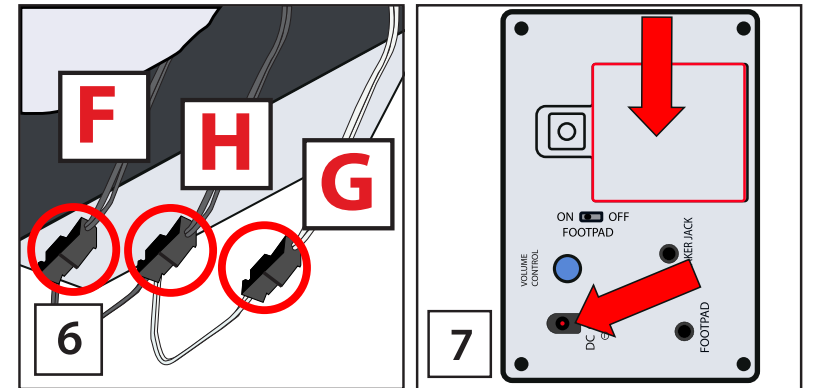
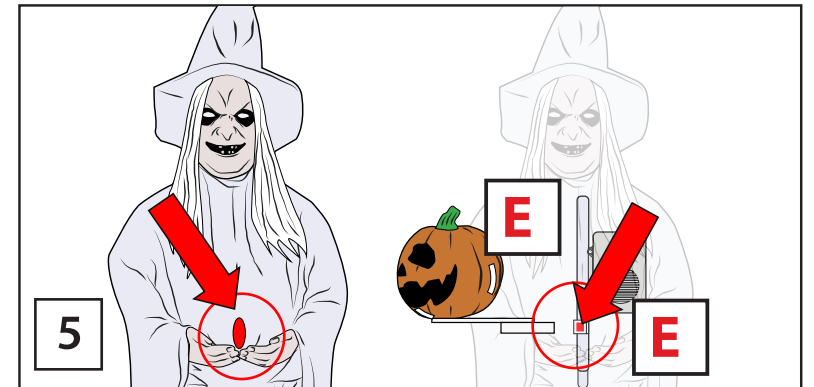
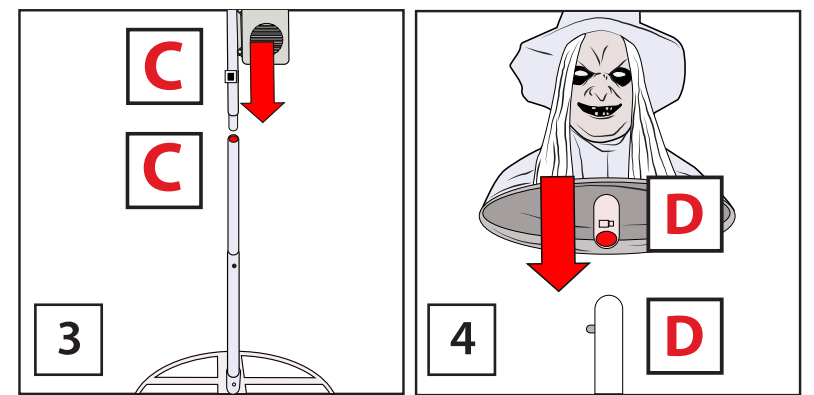
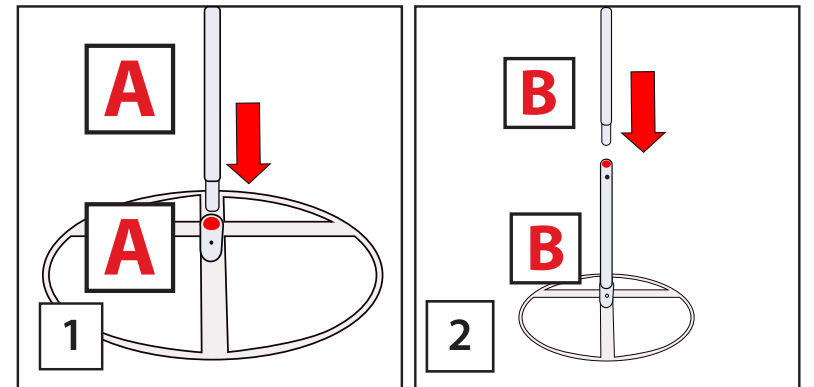

OPTIONAL FOOTPAD SET UP

FOOTPAD IS NOT INCLUDED. MUST BE PURCHASED SEPARATELY.

1. Insert the cable from optional footpad into the jack labeled FOOTPAD on the MODULE.
2. Place the switch in the FOOTPAD position to enable FOOTPAD activation.
3. Step on the FOOTPAD to activate the scary sequence!

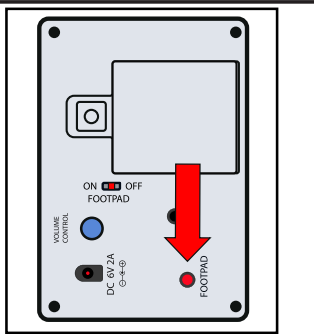

OPTIONAL EXTERNAL SPEAKER SET UP

EXTERNAL SPEAKER IS NOT INCLUDED. MUST BE PURCHASED SEPARATELY.

1. Plug speaker cord into the jack labeled SPEAKER JACK located on the MODULE.
2. Use volume knob on external speaker to control volume levels.

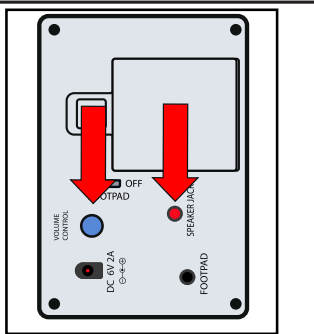

* Footpads and adapters are sold separately and can be purchased at www.tekkyaccessories.com

SMART PHONE SCAN SETUP VIDEO

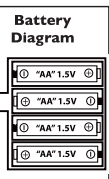

BATTERY INSTRUCTIONS AND CAUTIONS

Battery installation and removal should be performed by an adult. Remove batteries when not in use. Use only batteries recommended in the instructions. Do not mix new and used batteries. Do not mix alkaline, carbon-zinc, nickel-cadmium, rechargeable or different types of batteries. Be mindful to insert batteries with the correct polarity (+/-) as indicated. Remove all exhausted batteries. Rechargeable batteries are only to be charged under adult supervision. Rechargeable batteries are to be removed from the item before being charged. Non-rechargeable batteries are not to be recharged. The supply terminals are not to be short-circuited. Always dispose of exhausted batteries properly. Do NOT dispose of batteries in fire, they may leak or explode.

Warning! This item is not a toy. For decoration only. Small parts, choking hazard. This product is intended for use by persons 15 years of age and older. Not intended for use by children ages 14 years and younger.

WARNING DO NOT TURN ITEM ON UNTIL YOU HAVE COMPLETELY FINISHED ASSEMBLY. STAY CLEAR OF ITEM WHILE OPERATING. DO NOT PLACE ITEM ON UNEVEN GROUND. DO NOT PLACE WEIGHT ON ITEM WHILE IN OPERATION.



DO NOT RETURN THIS ITEM TO THE STORE! If experiencing technical difficulties, please go to www.tekkydesign.com for assistance.



visit us at tekkydesign.com
Requires 6V 2A ADAPTER (not included) or 4AA batteries (not included)

ALL NEW MATERIALS:
METAL, FOAM, PLASTIC, FABRIC
Surface washable only.

ANIMATED GHOST WITCH™
is a trademark of Tekky.
Copyright © 2021 Tekky.
All Rights Reserved.
MADE IN CHINA