

# EASY ASSEMBLY AND OPERATION INSTRUCTIONS

MR-127012 Cracked Victorian Doll



**Please follow the step by step guide and enjoy your Cracked Victorian Doll!**

## CARE AND STORAGE INSTRUCTIONS

For best performance operate your item indoors. When not in use, store this product in its original packing. Keep away from heat and moisture.

## WARNING

This item is not a toy and should be used for decoration only. This item contains small parts that can be a choking hazard. Keep all plastic and wire parts away from children. This product is intended for people ages 14 and up.

Please read all instructions carefully before assembling. Save this instruction sheet for future reference.

**BEFORE ASSEMBLING, REMOVE ALL THE ABOVE PARTS FROM BOX. IF ANY PART IS MISSING, PLEASE CONTACT CUSTOMER SERVICE AT SUPPORT@MORRIS COSTUMES.COM, OR BY PHONE 704-332-3304. IN YOUR EMAIL INQUIRY, PLEASE INCLUDE: YOUR ORDER NUMBER, WHO YOU BOUGHT IT FROM, AND WHAT SPECIFICALLY IS WRONG. THANK YOU.**



## ASSEMBLY INSTRUCTIONS

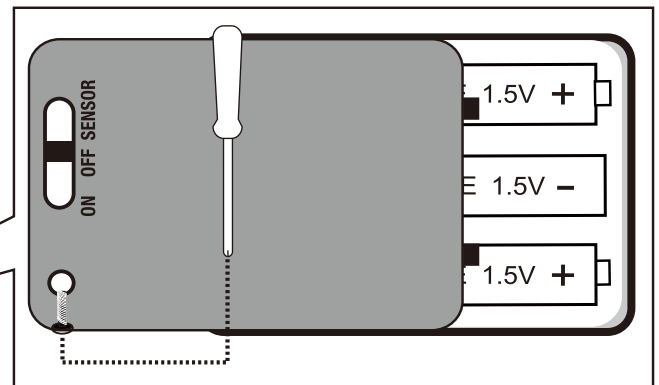
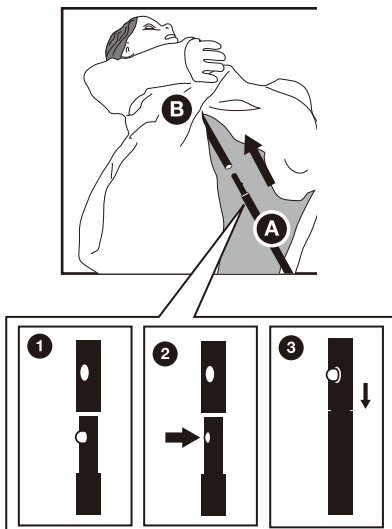

## OPERATION INSTRUCTIONS:

Cracked Victorian Doll has 3 operation settings which can be found on the main Function Control Box inside the (B) Cracked Victorian Doll:

- On: This setting allows the item to run continuously.
- Sensor: This setting will only activate lights and sounds when the motion sensor is activated.
- Off.

## BATTERY REPLACEMENT INSTRUCTIONS

You will need a small Phillips head screw driver.  
This is not a toy. For decorative use only.  
Requires 3 x AAA 1.5V batteries (Not Included)

Locate battery box on product. You must unscrew Phillips head screw before removing battery box cover. After removing or placing batteries into battery box, slide cover into position. Reset screw into position and tighten. Be careful not to over tighten. To activate light turn switch located above batteries to "on" position.

**NOTE:** assemble the (A) Base to the (B) Cracked Victorian Doll as shown, and secure by aligning the quick-connect push buttons into the pre-drilled holes.

Do not mix alkaline, standard (carbon-zinc), or rechargeable (nickel cadmium) batteries. Do not mix old and new batteries. Rechargeable batteries to be removed from the product before being charged. Only batteries of the same or equivalent type as recommended are to be used. Rechargeable batteries are only to be charged under adult supervision. Non-rechargeable batteries are not to be recharged. Batteries are to be inserted with the correct polarity. Remove batteries if consumed or if product is to be left unused for a long time. The supply terminals are not to be short-circuited. Dispose of batteries safely. **DO NOT DISPOSE OF BATTERIES IN FIRE, BATTERIES MAY EXPLODE OR LEAK.**

This device complies with Part 15 of the FCC Rules. Operation is subject to the following two conditions: (1) This device may not cause harmful interference, and (2) this device must accept any interference received, including interference that may cause undesired operation.

**CAUTION:** Changes or modifications not expressly approved by the party responsible for compliance could void the user's authority to operate the equipment.

**NOTE:** This equipment has been tested and found to comply with the limits for a Class B digital device, pursuant to Part 15 of the FCC Rules. These limits are designed to provide reasonable protection against harmful interference in a residential installation. This equipment generates, uses and can radiate radio frequency energy and, if not installed and used in accordance with the instructions, may cause harmful interference to radio communications. However, there is no guarantee that interference will not occur in a particular installation. If this equipment does cause harmful interference to radio or television reception, which can be determined by turning the equipment off and on, the user is encouraged to try to correct the interference by one or more of the following measures; Reorient or relocate the receiving antenna. Increase the separation between the equipment and receiver. Connect the equipment into an outlet on a circuit different from that to which the receiver is connected. Consult the dealer or experienced radio/TV technician for help.