

EASY ASSEMBLY AND OPERATION INSTRUCTIONS

MR-125152 Servo Carnival Barker



Please follow the step by step guide and enjoy your Servo Carnival Barker!

CARE AND STORAGE INSTRUCTIONS

For best performance operate your item indoors. When not in use, store this product in its original packing. Keep away from heat and moisture.

WARNING

This item is not a toy and should be used for decoration only. This item contains small parts that can be a choking hazard. Keep all plastic and wire parts away from children.

1. Please use the adapter supplied by manufacturer.
2. Please assemble item according to instructions. Connect all wires according to matching color.
3. Children should be supervised by adults. Item should not be grabbed, as it becomes a tipping hazard. Keep all away from the adapter, as it heats up during operation.

Please read all instructions carefully before assembling. Save this instruction sheet for future reference.

PARTS LIST

- A. Base x 1
- B. Poles x 4
- C. Box Top x 1
- D. Box Cover x 1
- E. Knee Poles x 2
- F. Shoes x 2
- G. Foam Tubes x 2
- H. Pants x 1
- I. Body Frame x 1
- J. Shirt x 1
- K. Left Arm x 1
- L. Right Arm x 1
- M. Left Hand x 1
- N. Right Hand and Megaphone x 1
- O. Back Frame x 1
- P. Head x 1
- Q. Hat x 1
- R. Step Pad x 1
- S. Universal Adapter (Included) x 1

Input: 100 - 240VAC 50/60Hz
Output: 5.9V 3.0A

BEFORE ASSEMBLING, REMOVE ALL THE ABOVE PARTS FROM BOX. IF ANY PART IS MISSING, PLEASE CONTACT CUSTOMER SERVICE AT SUPPORT@MORRISCOSTUMES.COM, OR BY PHONE 704-332-3304. IN YOUR EMAIL INQUIRY, PLEASE INCLUDE: YOUR ORDER NUMBER, WHO YOU BOUGHT IT FROM, AND WHAT SPECIFICALLY IS WRONG. THANK YOU.

STEP 1
Attach the (B) Poles to the (A) Base using the quick connect push buttons and pre-drilled holes as shown in Figure 1.
Attach the (C) Box Top to the (B) Poles using the quick connect push buttons and pre-drilled holes as shown in Figure 2.
Place the (D) Box Cover over the (C) Box Top and (B) Poles so that the holes in the (D) Box Cover line up with the poles on the (C) Box Top. Secure the (D) Box Cover to itself using the hook and loop closure as shown in Figure 3.

STEP 2
Slide the (E) Knee Poles through the (F) Shoes and attach to the (C) Box Top using the quick connect push buttons and pre-drilled holes as shown in Figure 1.
Slip the (G) Foam Tubes over the (E) Knee Poles as shown in Figure 2.
Slip the (H) Pants over the (G) Foam Tubes so that the tag of the (H) Pants is facing the back as shown in Figure 3.

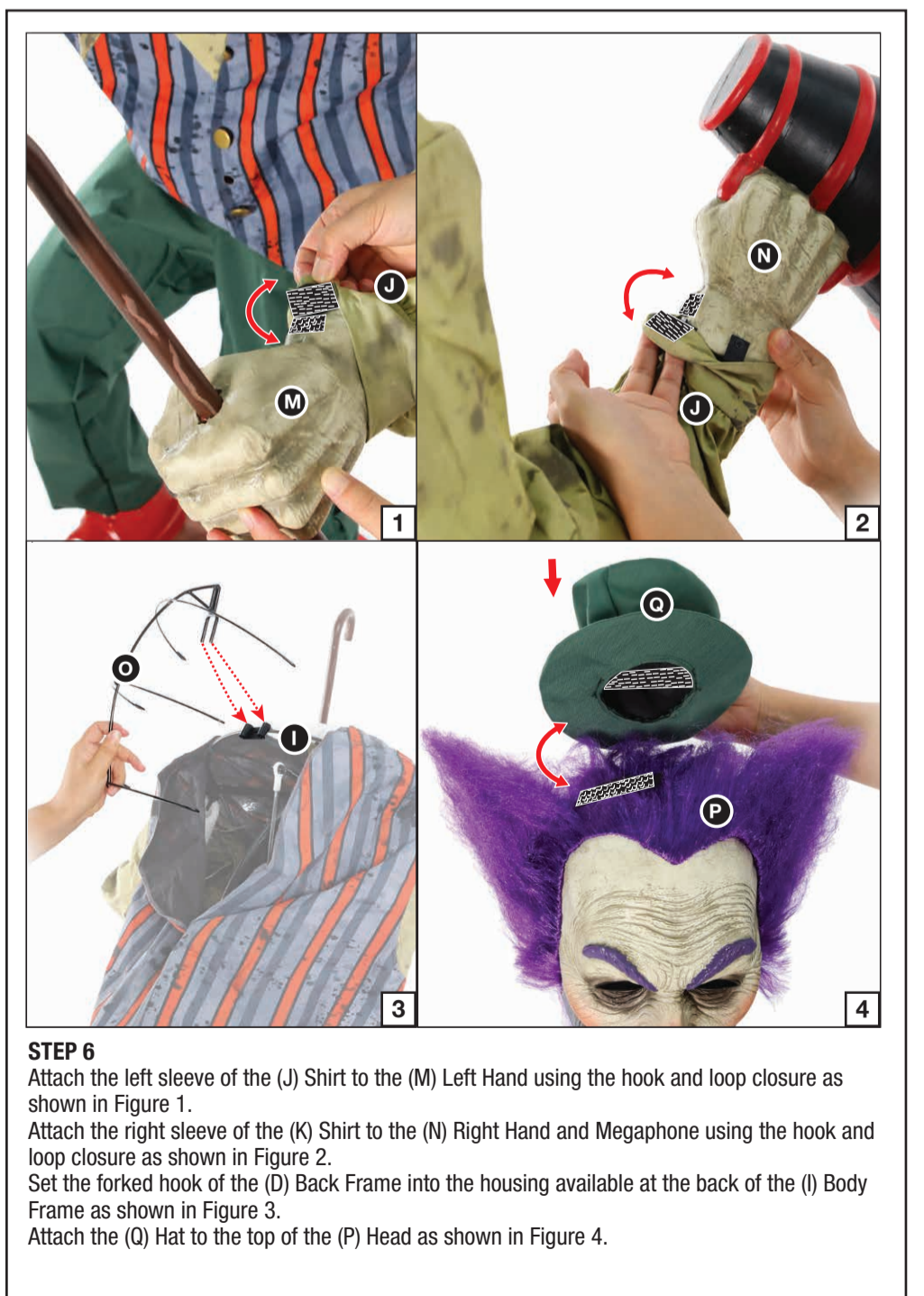
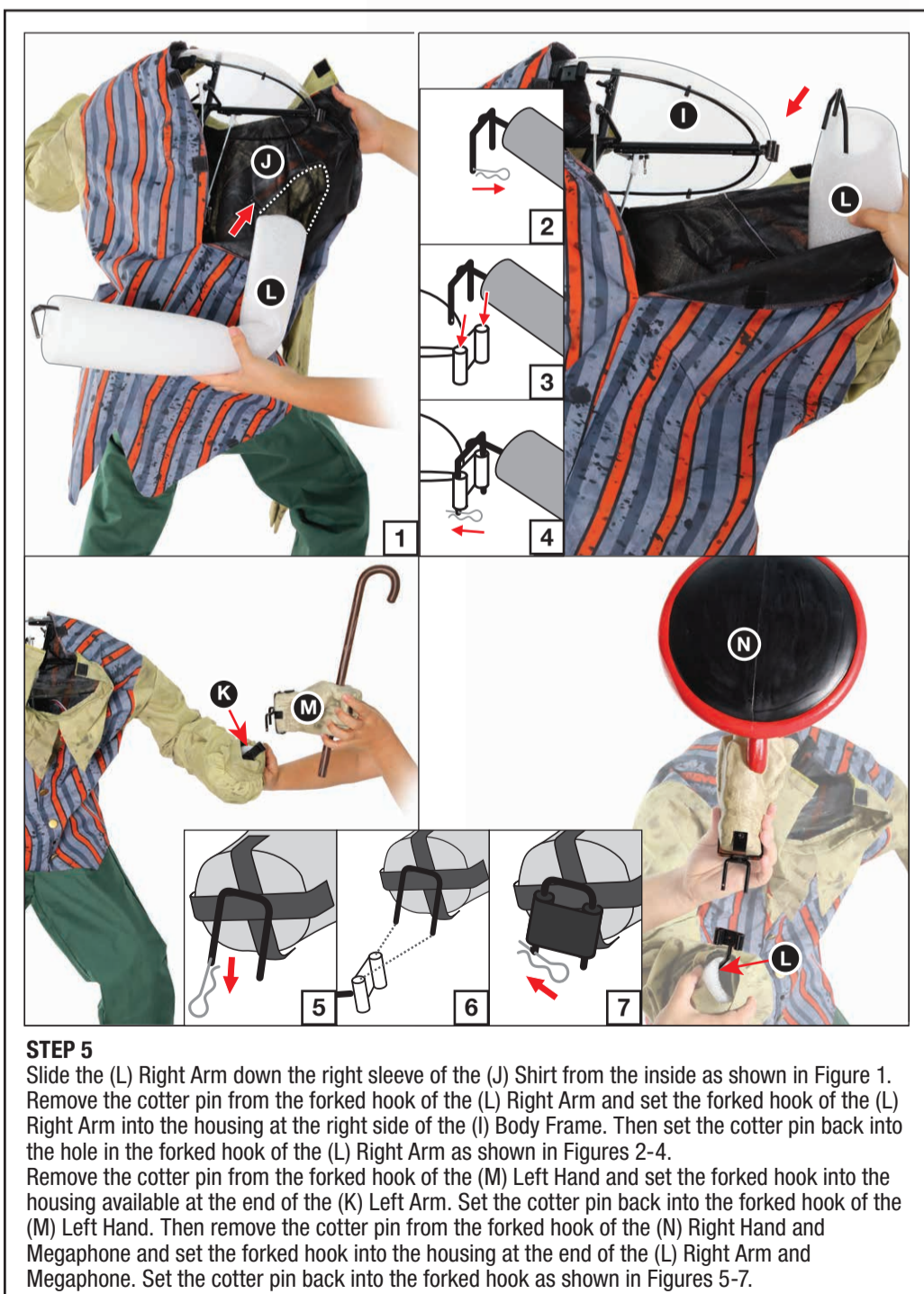
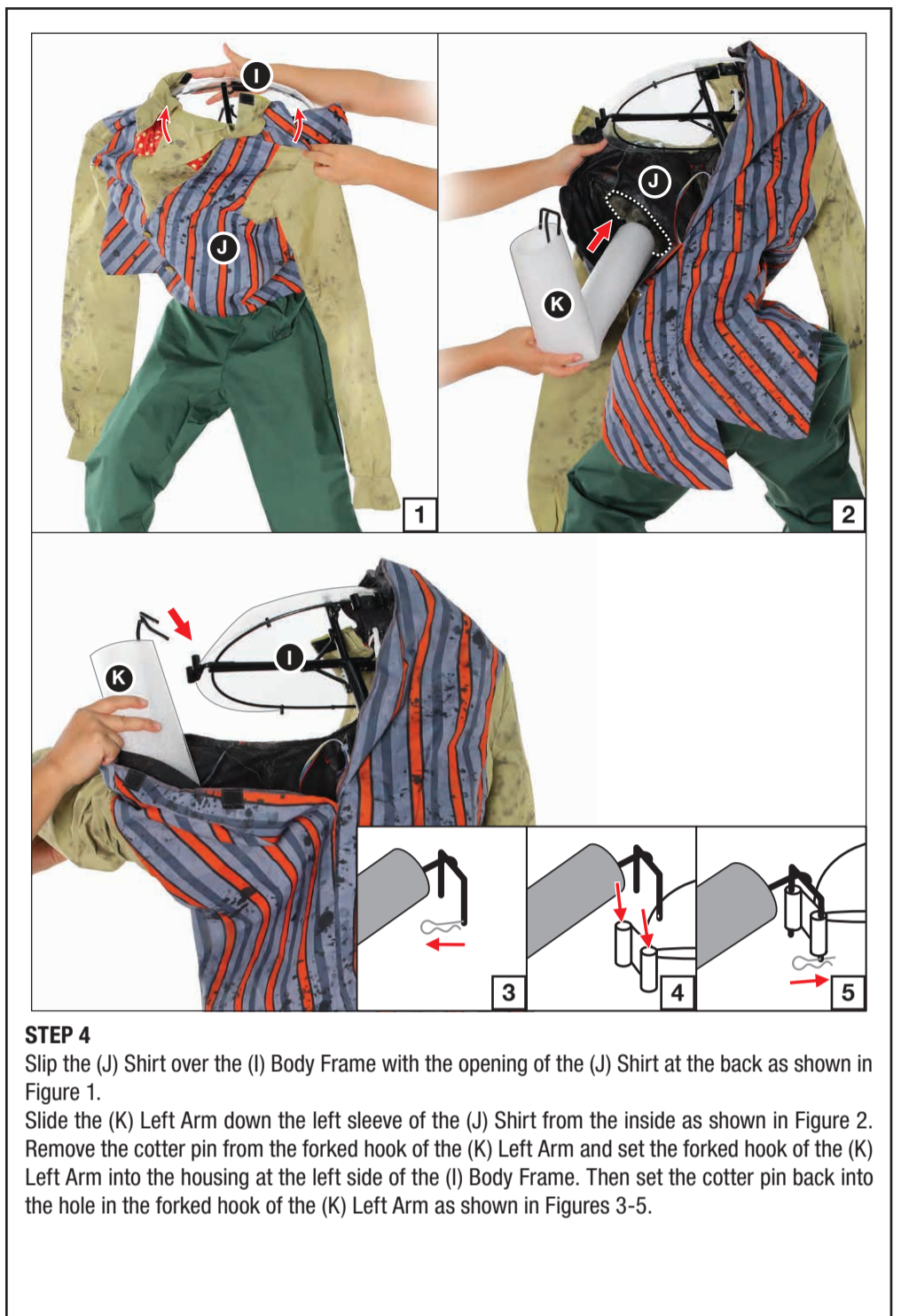
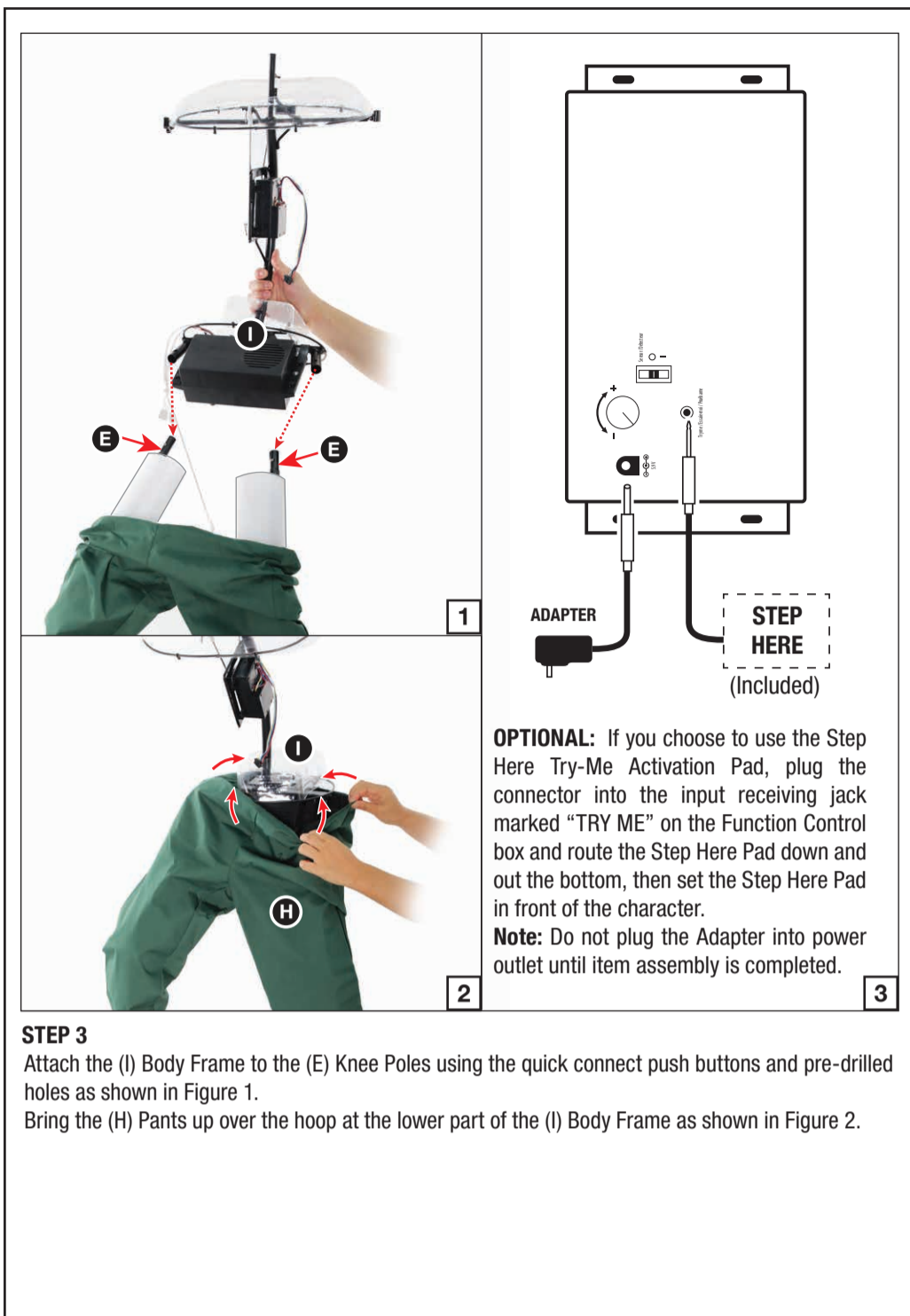

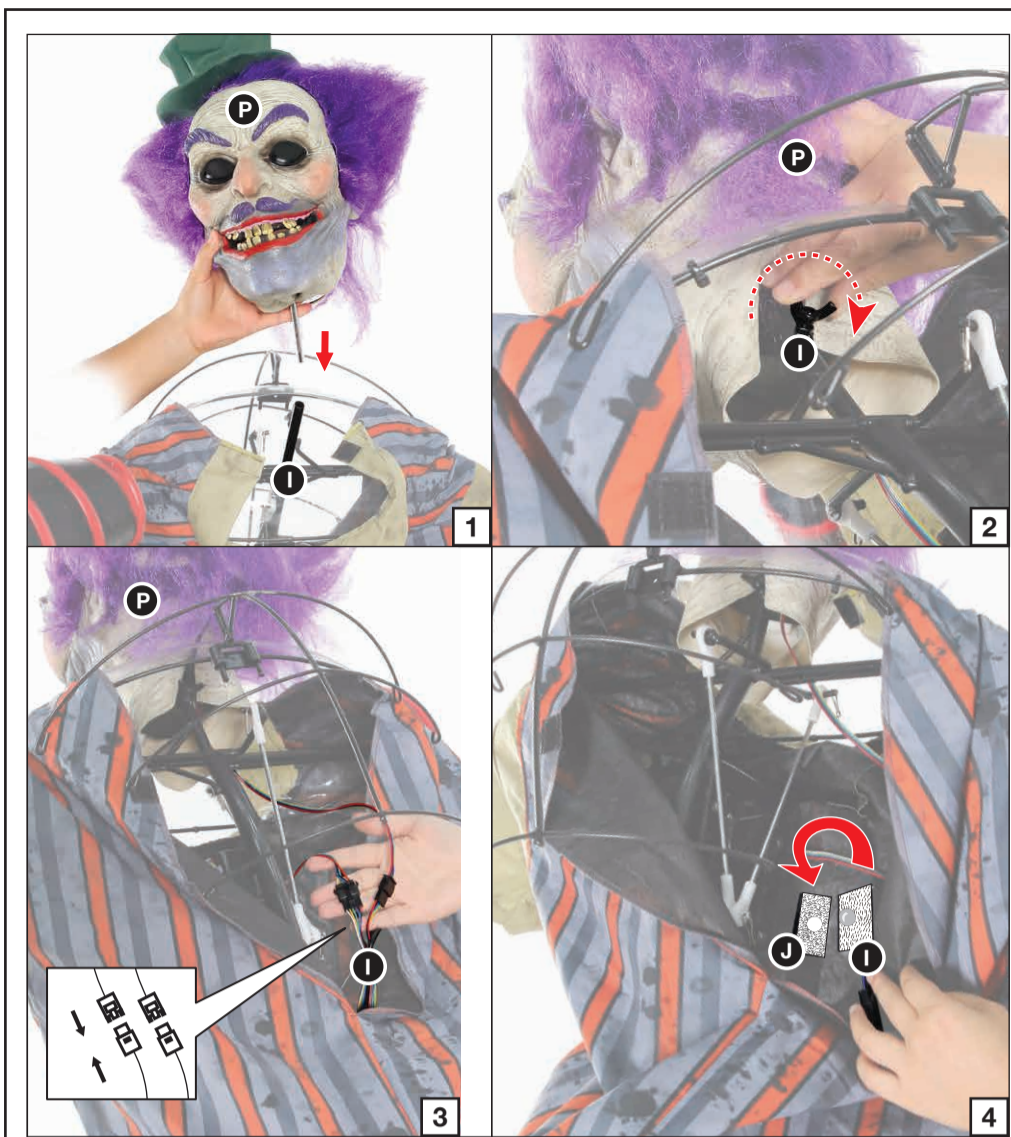

STEP 7

Set the bottom of the (P) Head into the housing available at the top of the (I) Body Frame as shown in Figure 1. Tighten the thumbscrew by the neck to secure the (P) Head in place as shown in Figure 2. Connect all cables to their corresponding cables by shape and color as shown in Figure 3. Secure the Sensor to the front inner surface of the (J) Shirt using the hook and loop closure so that the sensor emerges from the hole as shown in Figure 4.

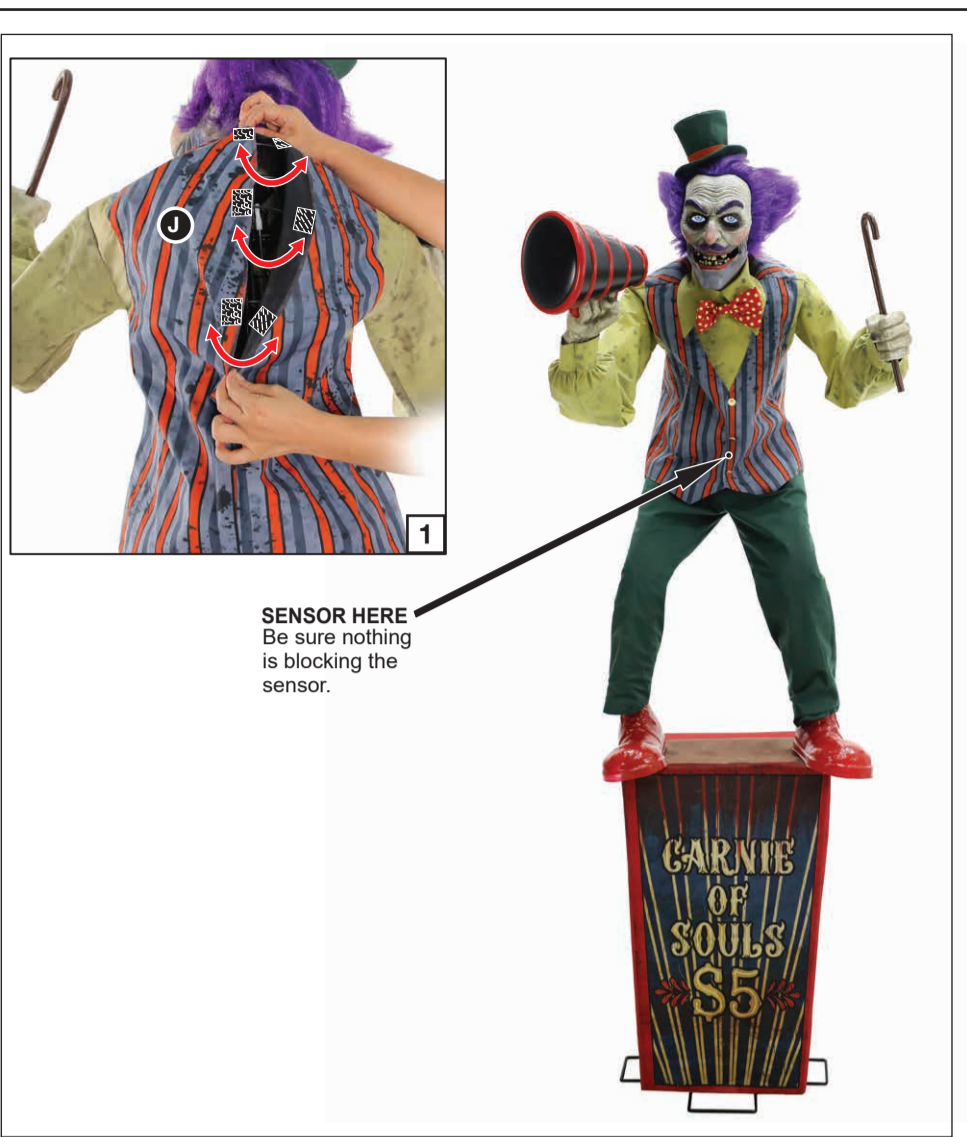

SENSOR HERE
Be sure nothing is blocking the sensor.

STEP 8

Close the back of the (J) Shirt using the hook and loop closures as shown in Figure 1. Your Servo Carnival Barker is now fully assembled. Plug in and turn on to let the fun begin!

OPERATION INSTRUCTIONS:

1. Plug the power adapter into a standard power outlet and adjust the settings on the Function Control Box, located on the (I) Body Frame, as desired.

2. Settings:

Sensor /Détecteur	This switch mode will activate the LCD eyes, sound, and animation when the Infra-red (IR) sensor is activated and will operate for 1 audio-cycle with each activation. The Infra-red (IR) sensor has a range of up to 2 m/6.5 ft. and will activate when someone comes within an 80-degree angle from left-to-right, as well as from above and below.
○	This switch mode allows the item to be activated only if triggered by using a Step Here Try Me Activation Pad (Included). The item will operate for one audio cycle with each Try Me activation.
I	This switch mode will continually operate the LCD eyes, sound, and animation of the item.
⌚	Raise or lower the volume using the volume control turn dial, turn all the way down to turn the sound off.

This device complies with Part 15 of the FCC Rules. Operation is subject to the following two conditions: (1) This device may not cause harmful interference, and (2) this device must accept any interference received, including interference that may cause undesired operation.

CAUTION: Changes or modifications not expressly approved by the party responsible for compliance could void the user's authority to operate the equipment.

NOTE: This equipment has been tested and found to comply with the limits for a Class B digital device, pursuant to Part 15 of the FCC Rules. These limits are designed to provide reasonable protection against harmful interference in a residential installation. This equipment generates, uses and can radiate radio frequency energy and, if not installed and used in accordance with the instructions, may cause harmful interference to radio communications. However, there is no guarantee that interference will not occur in a particular installation. If this equipment does cause harmful interference to radio or television reception, which can be determined by turning the equipment off and on, the user is encouraged to try to correct the interference by one or more of the following measures: Reorient or relocate the receiving antenna, increase the separation between the equipment and receiver, Connect the equipment into an outlet on a circuit different from that to which the receiver is connected. Consult the dealer or experienced radio/TV technician for help.

