

EASY ASSEMBLY AND OPERATION INSTRUCTIONS

MR-124910 Lunging Reaper With Digit Eyes



Please follow the step by step guide and enjoy your Lunging Reaper With Digit Eyes!

CARE AND STORAGE INSTRUCTIONS

For best performance, operate your item indoors. When not in use, store this product in its original packing. Keep away from heat and moisture.

WARNING

- This item is not a toy and should be used for decoration only. This item contains small parts that can be a choking hazard. Keep all plastic and wire parts away from children.
1. Please use the adapter supplied by the manufacturer.
 2. Please assemble the item according to the instructions. Connect all wires according to to their matching color.
 3. Children should be supervised by adults. The item should not be grabbed, as it becomes a tipping hazard. Keep away from the adapter, as it heats up during operation.

Please read all instructions carefully before assembling. Save this instruction sheet for future reference.

PARTS LIST

- A. Base x 1
 - B. Support Poles x 4
 - C. Torso Frame x 1
 - D. Hip Hoop x 1
 - E. Shoulder Support x 1
 - F. Sensor x 1
 - G. Costume x 1
 - H. Head x 1
 - I. Right Arm x 1
 - J. Right Hand x 1
 - K. Left Arm x 1
 - L. Lower Scythe Pole x 1
 - L1. Middle Scythe Poles x 2
 - L2. Upper Scythe Pole x 1
 - M. Scythe Top x 1
 - N. Hood x 1
 - O. Rope Belt x 1
 - P. Step Pad x 1
 - Q. Universal Adapter (Included)
- Input: 100 - 240V AC 50/60Hz
Output: 5.9V 3.0A

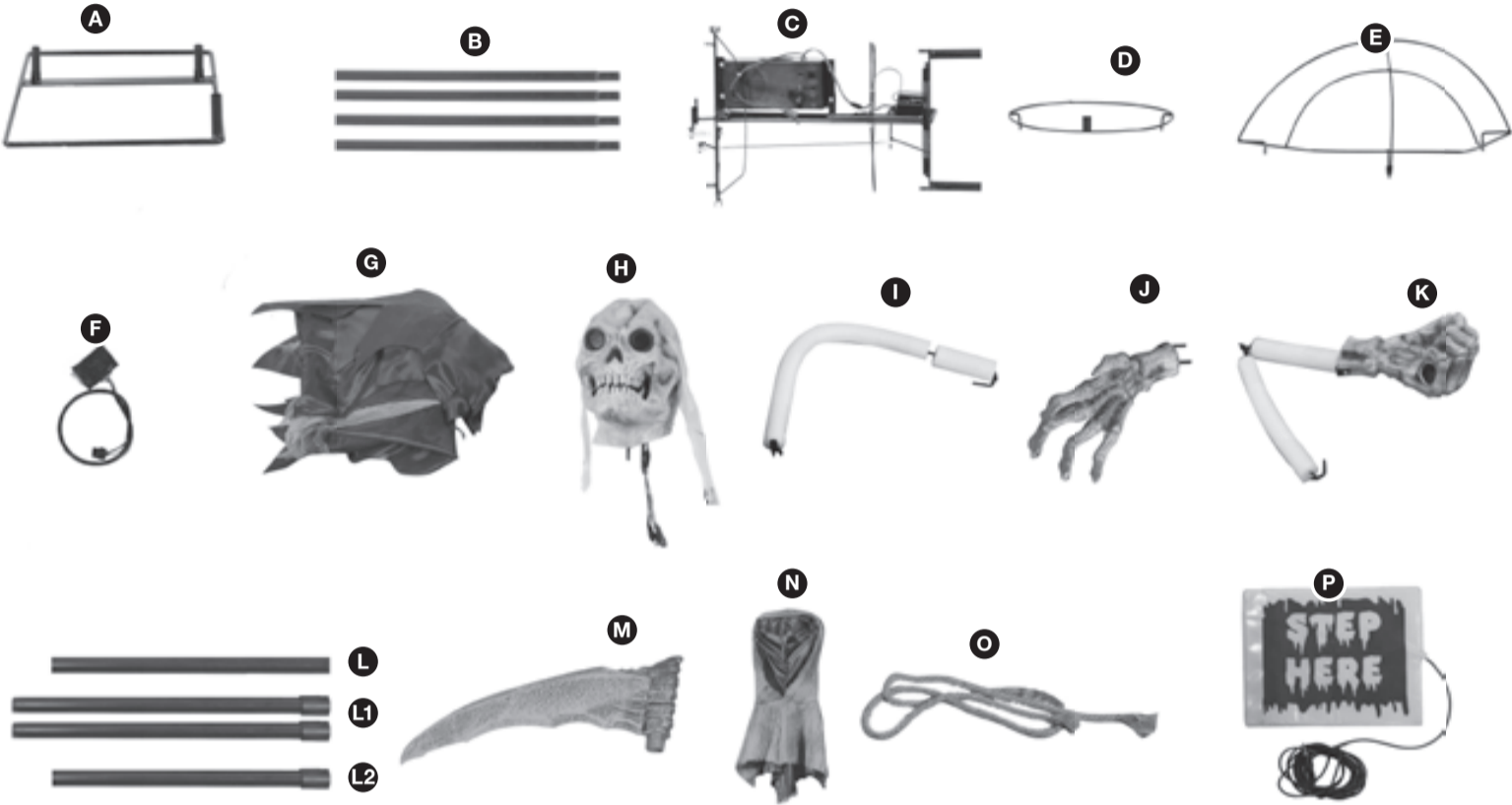

BEFORE ASSEMBLING, REMOVE ALL THE ABOVE PARTS FROM BOX. IF ANY PART IS MISSING, PLEASE CONTACT CUSTOMER SERVICE AT SUPPORT@MORRISCOSTUMES.COM, OR BY PHONE 704-332-3304. IN YOUR EMAIL INQUIRY, PLEASE INCLUDE: YOUR ORDER NUMBER, WHO YOU BOUGHT IT FROM, AND WHAT SPECIFICALLY IS WRONG. THANK YOU.

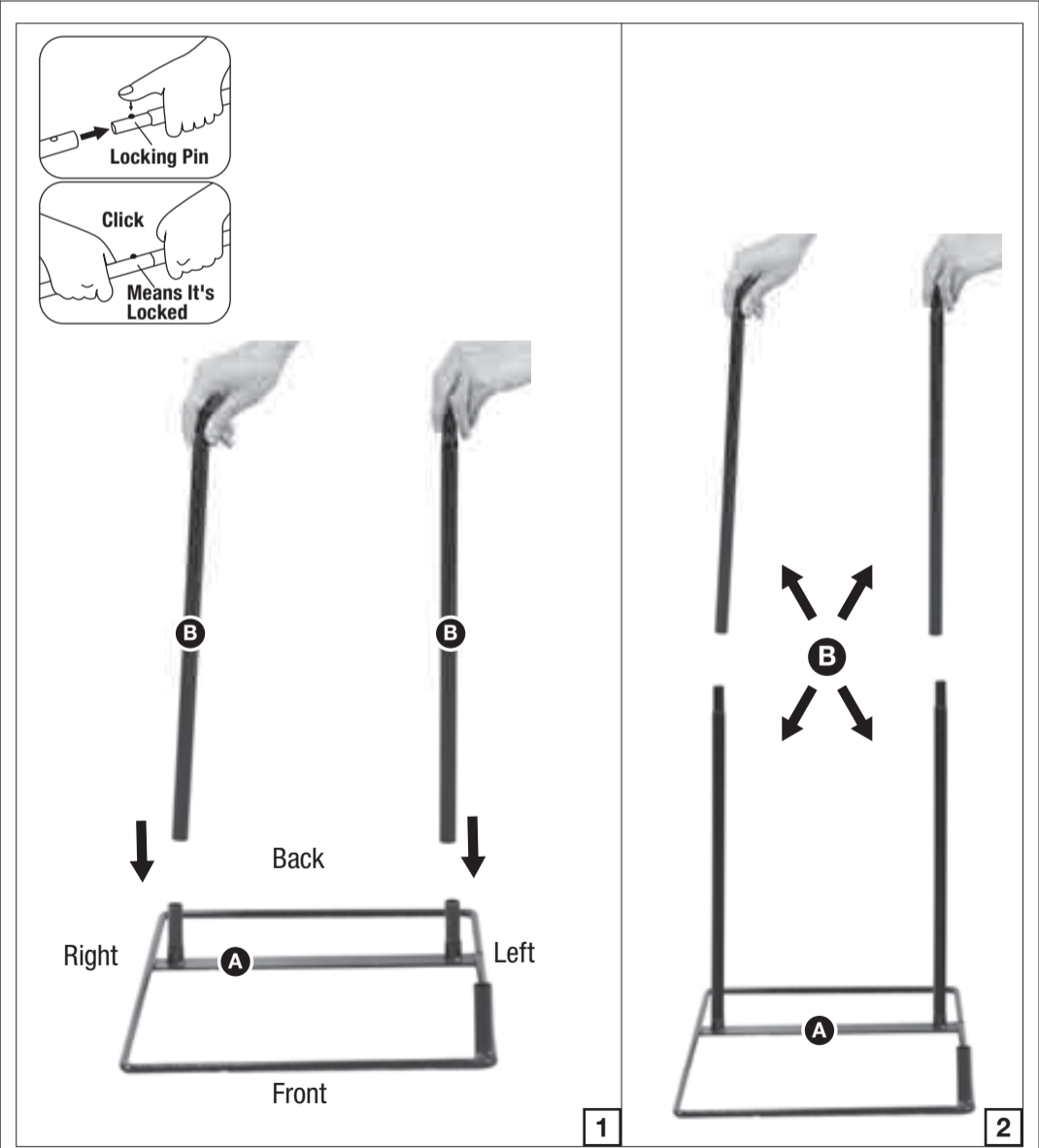

STEP 1
Note: Throughout the instructions, right and left are relative to the character.
Attach the (B) Support Poles to the (A) Base and secure by aligning the quick connect push buttons into the pre-drilled holes as shown in Figure 1.
Attach the other (B) Support Poles to the assembled (B) Support Poles and secure by aligning the quick connect push buttons into the pre-drilled holes as shown in Figure 2.

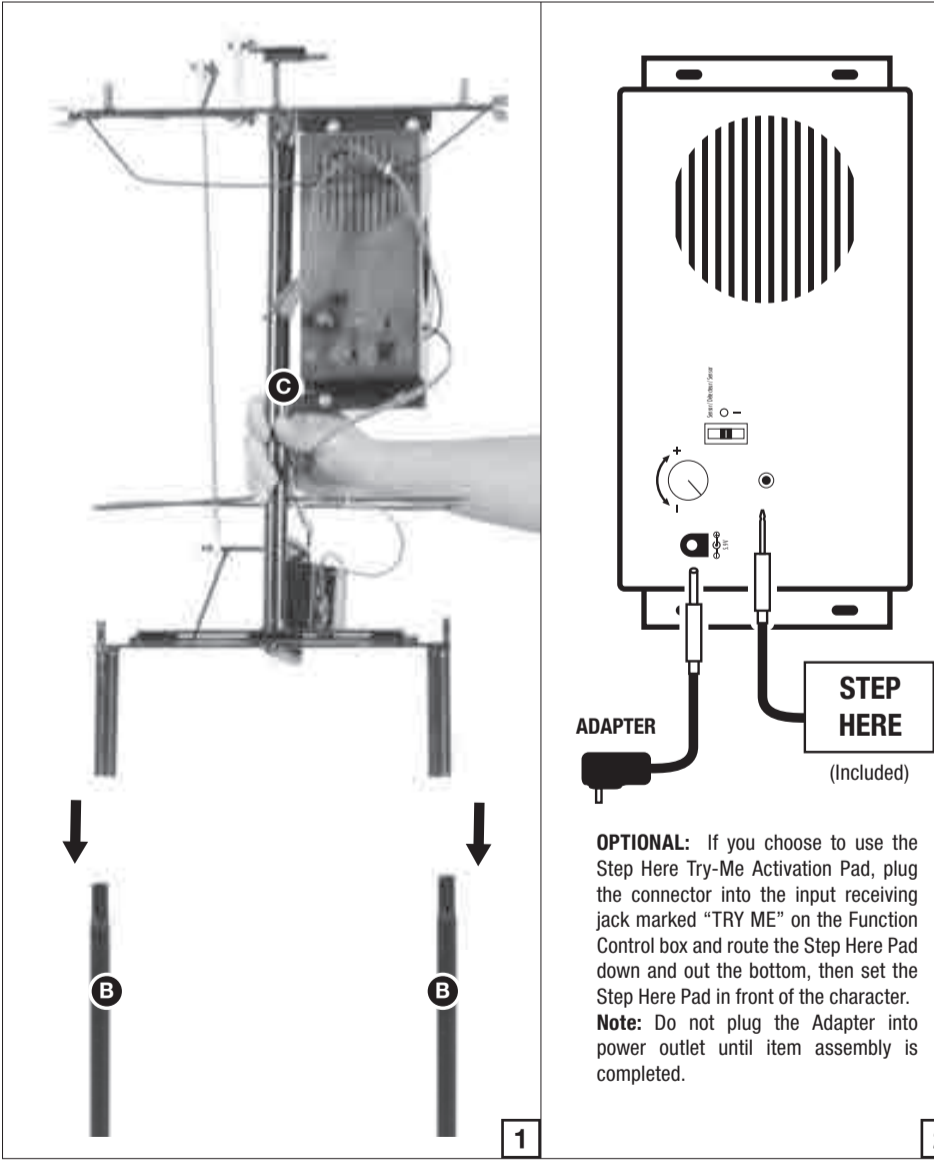

STEP 2
NOTE: The speaker on the Function Control Box located on the (C) Torso Frame should be facing front.
Assemble the (C) Torso Frame onto the (B) Support Poles and secure by aligning the quick connect push buttons into the pre-drilled holes as shown in Figure 1.
Now, plug the Adapter into the input receiving jack marked "DC 5.9V" on the Function Control Box.

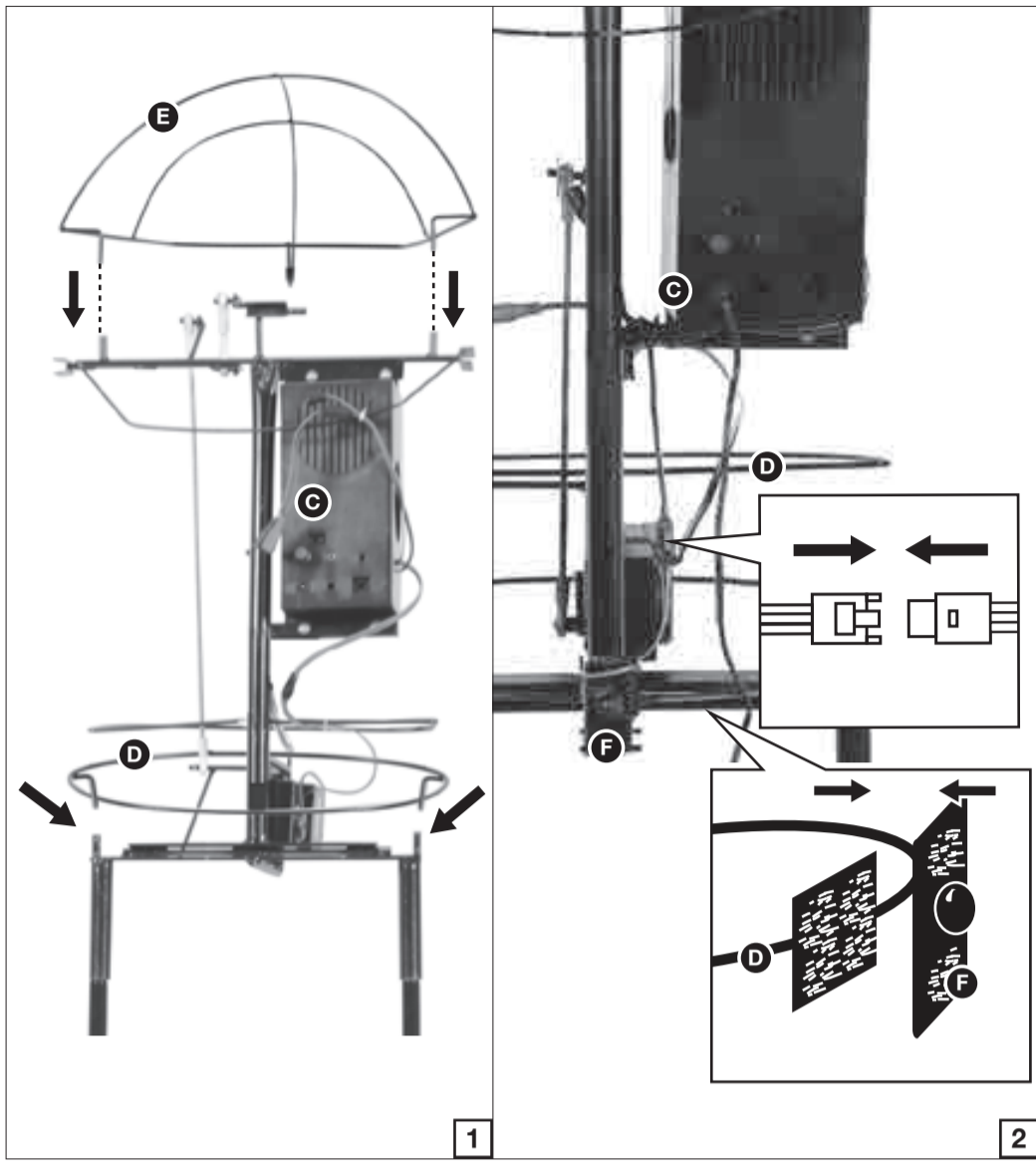

STEP 3

Lower the (D) Hip Hoop down over the (C) Torso Frame and attach through the slots located on the sides at the bottom of the (C) Torso Frame as shown. Attach the (E) Shoulder Support into the slots located at the top of the (C) Torso Frame as shown in Figure 1.

Attach the (F) Sensor on the (D) Hip Hoop located on the (C) Torso Frame by the hook & loop closures then locate the flat pin connector sensor cable from the (F) Sensor to the corresponding cable on the Function Control box on the (C) Torso Frame as shown in Figure 2.

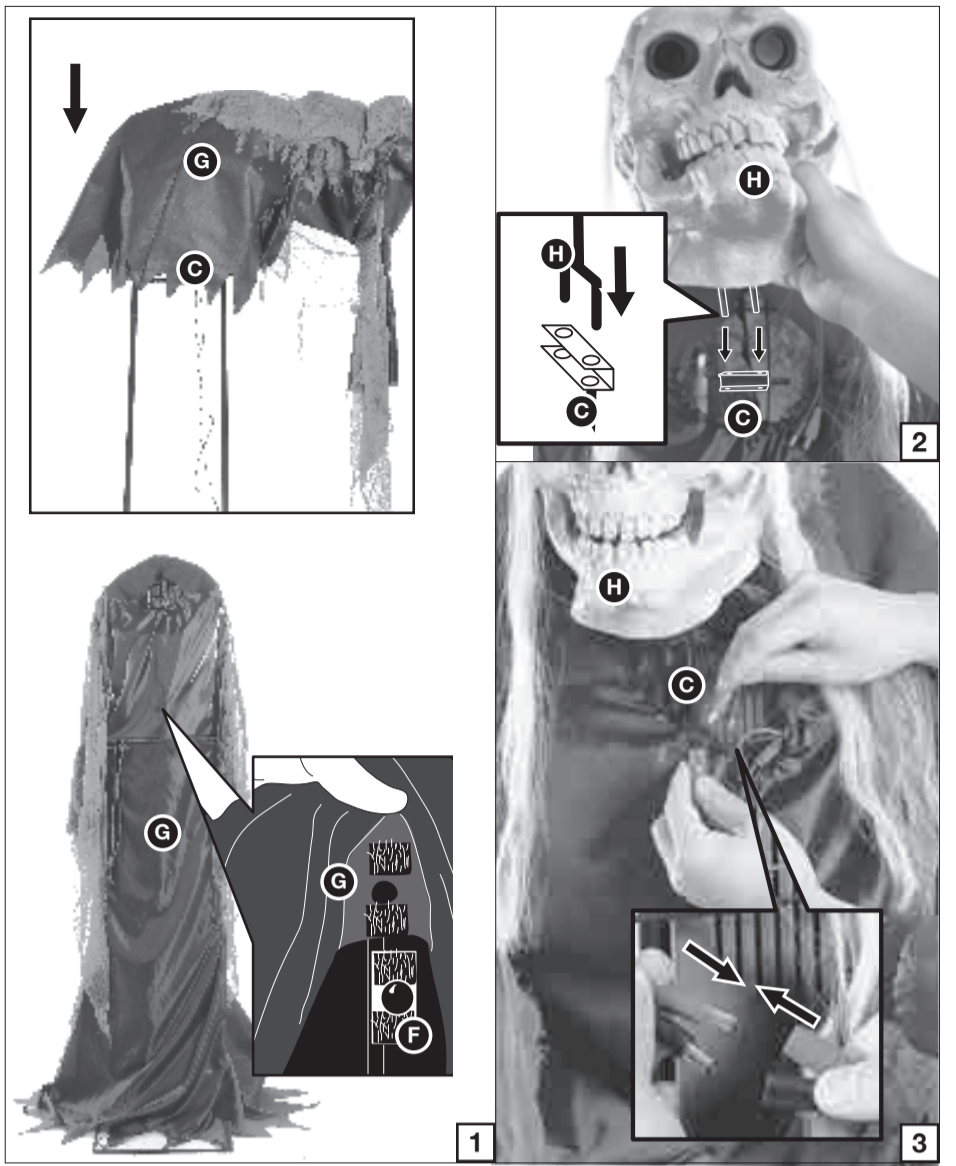

STEP 4

Lower the (G) Costume down over the (E) Shoulder Support & (C) Torso Frame so that the (G) Costume opens at the back.

Secure the (F) Sensor and the (G) Costume with the hook and loop closures inside (G) Costume as shown.

Note: The rope belt is pre-attached to the costume.

Then, set the (H) Head onto the (C) Torso Frame by sliding the forked-hook into the “neck” slot housing on the (C) Torso Frame, and connect the cables from the (H) Head to the color-coordinated cables on the Function Control box on the (C) Torso Frame as shown.

Now you can secure the hook & loop closures at the back of the (G) Costume.

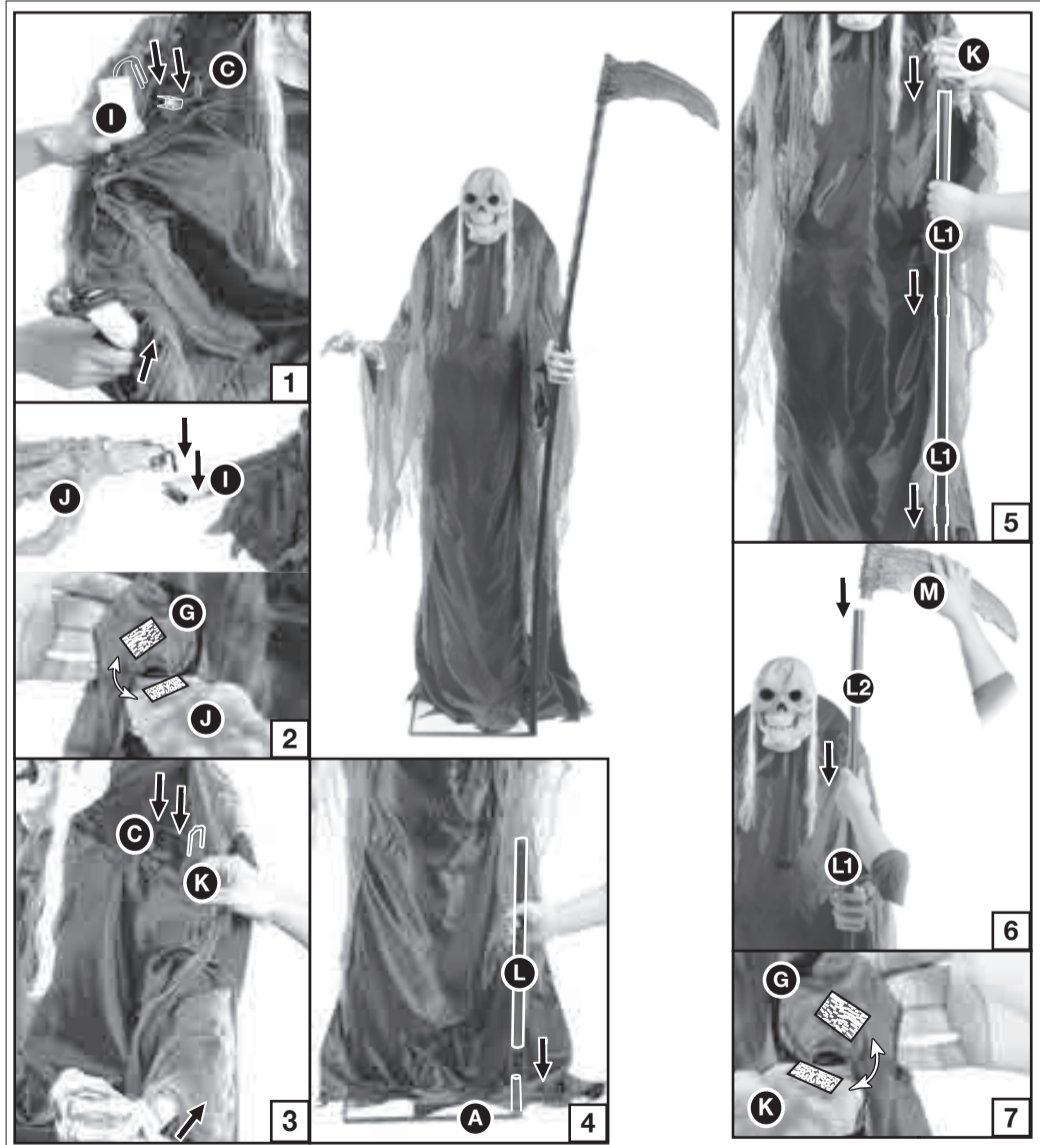

STEP 5

Slide the (I) Right Arm up through the right sleeve and slide the forked-hook into the right “shoulder” slot housing on the (C) Torso Frame as shown in Figure 1. Slide the forked hook of the (J) Right Hand into the slot located on the (I) Right Arm then secure the hook & loop closures at the wrist as shown in Figure 2. Slide the (K) Left Arm up through the left sleeve and slide the forked-hook into the left “shoulder” slot housing on the (C) Torso Frame as shown in Figure 3. Assemble the (L) Lower Scythe Pole to the (A) Base as shown in Figure 4. Assemble two pieces of the (L1) Middle Scythe Poles together and slide to the (L) Lower Scythe Pole then slide through the hole of the hand on the end of the (K) Left Arm onto the top of the assembled (L1) Middle Scythe Poles as shown in Figure 5. Assemble the (L2) Upper Scythe Pole to the (L1) Middle Scythe Poles and set the (M) Scythe Top on top as shown in Figure 6. Secure the hook & loop closures at the wrist as shown in Figure 7.

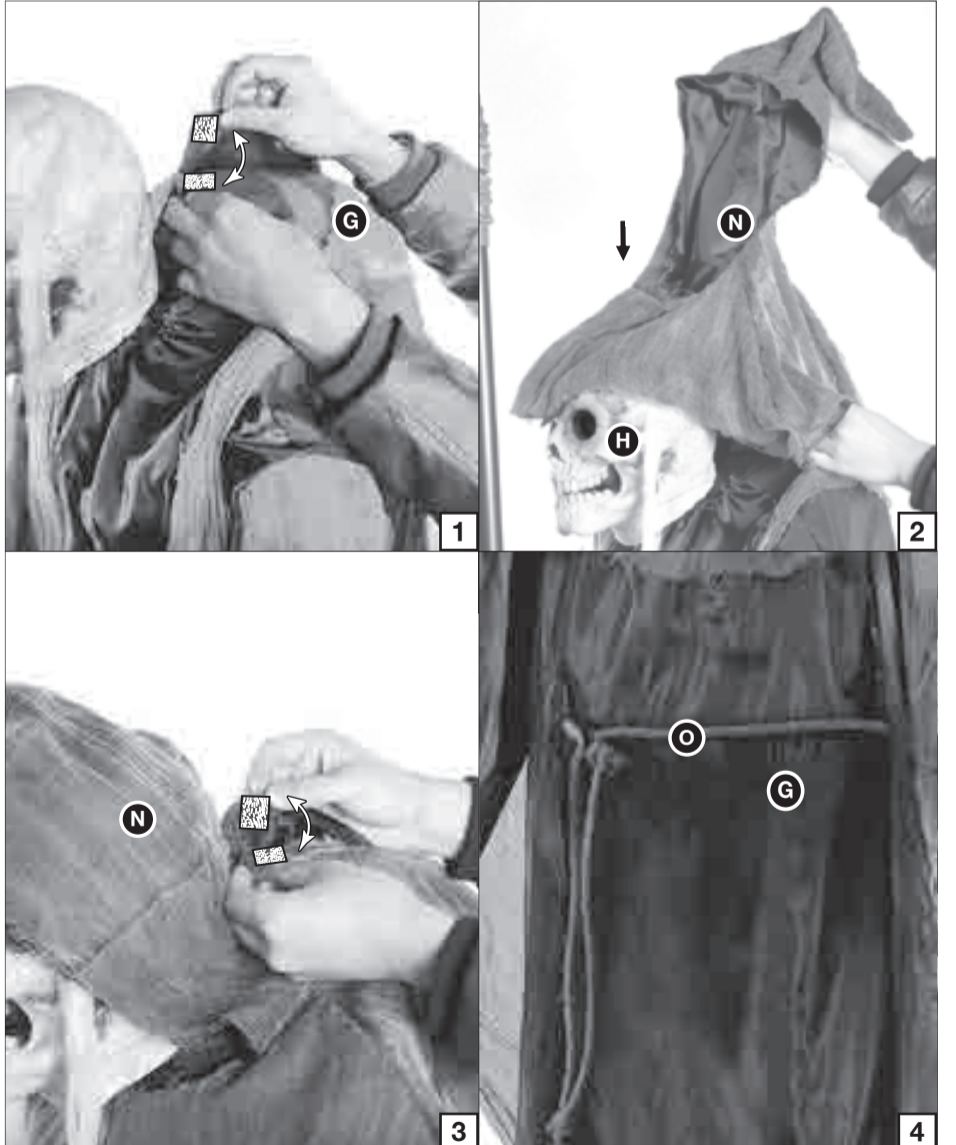

STEP 6

Secure the back of the (G) Costume by using the available hook & loop closures as shown in Figure 1.

Set the (N) Hood up onto the (H) Head and shoulders and secure under the chin and at the back with the hook & loop closures as shown in Figures 2 & 3.

Wrap the (O) Rope Belt around the top of the (G) Costume and tie in the front as shown in Figure 4.

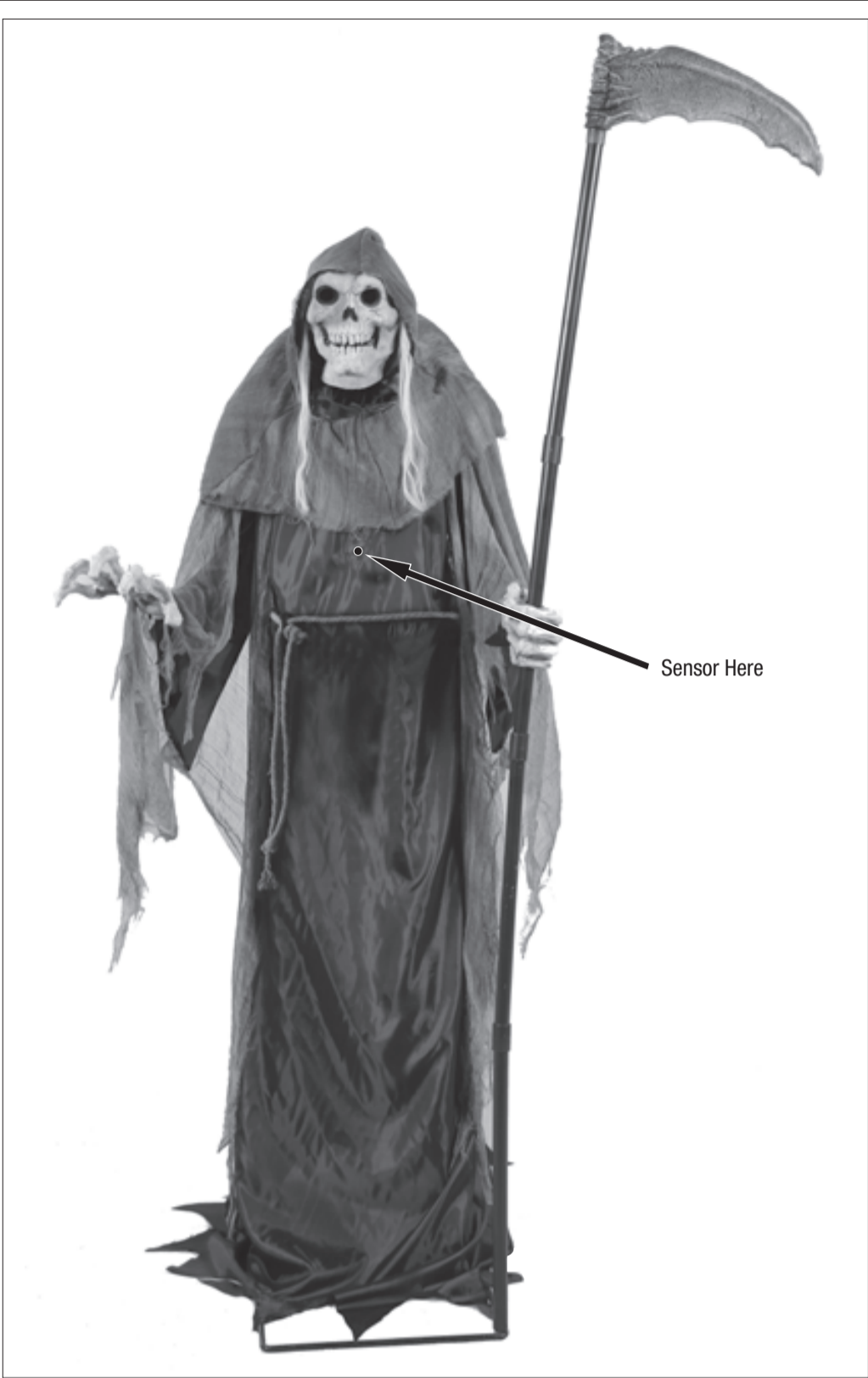

STEP 7
Your Lunging Reaper With Digit Eyes is now fully assembled. Plug in and turn on to let the fun begin!

OPERATION INSTRUCTIONS:

- 1. Plug the Adapter into a standard power outlet and adjust the settings on the Function Control Box as desired.
- 2. Settings:
Sensor: This switch mode will activate lights, sound, and animation when the Infra-red (IR) sensor is activated and will operate for 1 audio-cycle with each activation. The Infra-red (IR) sensor has a range of up to 2 m/6.5 ft. and will activate when someone comes within an 80-degree angle from left-to-right, as well as from above and below.
○/OFF/Try Me: This switch mode allows the item to be activated only if triggered by using a Step Here Try Me Activation Pad. The item will operate for one audio cycle with each Try Me activation. Refer to Assembly Instructions Step 2 for further details.
I / ON : This switch mode will continuously operate the lights, sound, and animation of the item.

 : Raise or lower the volume using the volume control turn dial, turn all the way down to turn the volume off.

This device complies with Part 15 of the FCC Rules. Operation is subject to the following two conditions: (1) This device may not cause harmful interference, and (2) this device must accept any interference received, including interference that may cause undesired operation.

CAUTION: Changes or modifications not expressly approved by the party responsible for compliance could void the user’s authority to operate the equipment.

NOTE: This equipment has been tested and found to comply with the limits for a Class B digital device, pursuant to Part 15 of the FCC Rules. These limits are designed to provide reasonable protection against harmful interference in a residential installation. This equipment generates, uses, and can radiate radio frequency energy and, if not installed and used in accordance with the instructions, may cause harmful interference to radio communications. However, there is no guarantee that interference will not occur in a particular installation. If this equipment does cause harmful interference to radio or television reception, which can be determined by turning the equipment off and on, the user is encouraged to try to correct the interference by one or more of the following measures: Reorient or relocate the receiving antenna, Increase the separation between the equipment and receiver, Connect the equipment into an outlet on a circuit different from that to which the receiver is connected. Consult the dealer or experienced radio/TV technician for help.

