

# EASY ASSEMBLY AND OPERATION INSTRUCTIONS

MR-124761 Looming Clown

Please follow the step by step guide and enjoy your Looming Clown!

## CARE AND STORAGE INSTRUCTIONS

For best performance operate your item indoors. When not in use, store this product in its original packing. Keep away from heat and moisture.

## WARNING

This item is not a toy and should be used for decoration only. This item contains small parts that can be a choking hazard. Keep all plastic and wire parts away from children.

1. Please use the adapter supplied by manufacturer.
2. Please assemble item according to instructions. Connect all wires according to matching color.
3. Children should be supervised by adults. Item should not be grabbed, as it becomes a tipping hazard. Keep all away from the adapter, as it heats up during operation.

Please read all instructions carefully before assembling. Save this instruction sheet for future reference.

## PARTS LIST

- A. Base x 1
  - B. Shoes x 2
  - C. Right Support Pole x 1
  - D. Left Support Pole x 1
  - E. Foam Tubes x 10
  - F. Middle Support Poles x 6
  - G. Upper Support Poles x 2
  - H. Pants x 1
  - I. Hip Frame x 1
  - J. Hip Hoop x 1
  - K. Torso Frame x 1
  - L. Spinal Frame x 1
  - M. Costume x 1
  - N. Right Arm x 1
  - O. Left Arm x 1
  - P. Right Hand x 1
  - Q. Left Hand x 1
  - R. Head x 1
  - S. Collar x 1
  - T. Door Curtain x 1
  - U. Extended line x 1
  - V. Step Pad x 1
  - W. Adapter (Included) x 1
- Input: 100 - 240VAC 50/60Hz  
Output: 5.9V 1.5A



**BEFORE ASSEMBLING, REMOVE ALL THE ABOVE PARTS FROM BOX. IF ANY PART IS MISSING OR BROKEN, PLEASE CONTACT CUSTOMER SERVICE AT SUPPORT@MORRISCOSTUMES.COM, OR BY PHONE 704-332-3304. IN YOUR EMAIL INQUIRY, PLEASE INCLUDE: YOUR ORDER NUMBER, WHO YOU BOUGHT IT FROM, AND WHAT SPECIFICALLY IS WRONG. THANK YOU.**

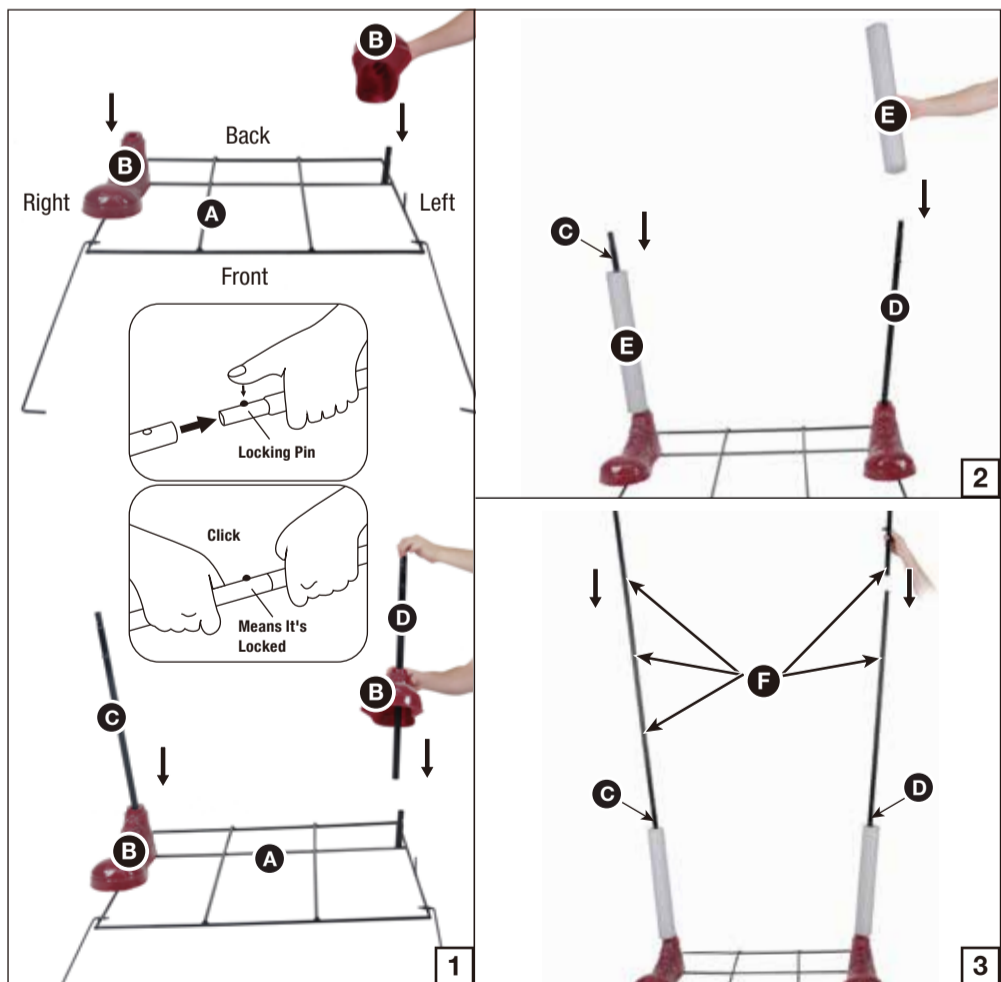

### STEP 1

Note: Left and Right are relative to the character. A Ladder is recommended for assembly. Two person assembly is recommended.  
Lower the (B) Shoes onto the (A) Base and attach the (C & D) Support Poles through the (B) Shoes to the (A) Base and secure by aligning the quick-connect push buttons into the pre-drilled holes as shown in Figure 1.  
Slide the (E) Foam Tubes over the (C & D) Support Poles as shown in Figure 2.  
Attach the (F) Middle Support Poles to the (C & D) Support Poles and secure by aligning the quick-connect push buttons into the pre-drilled holes as shown in Figure 3.

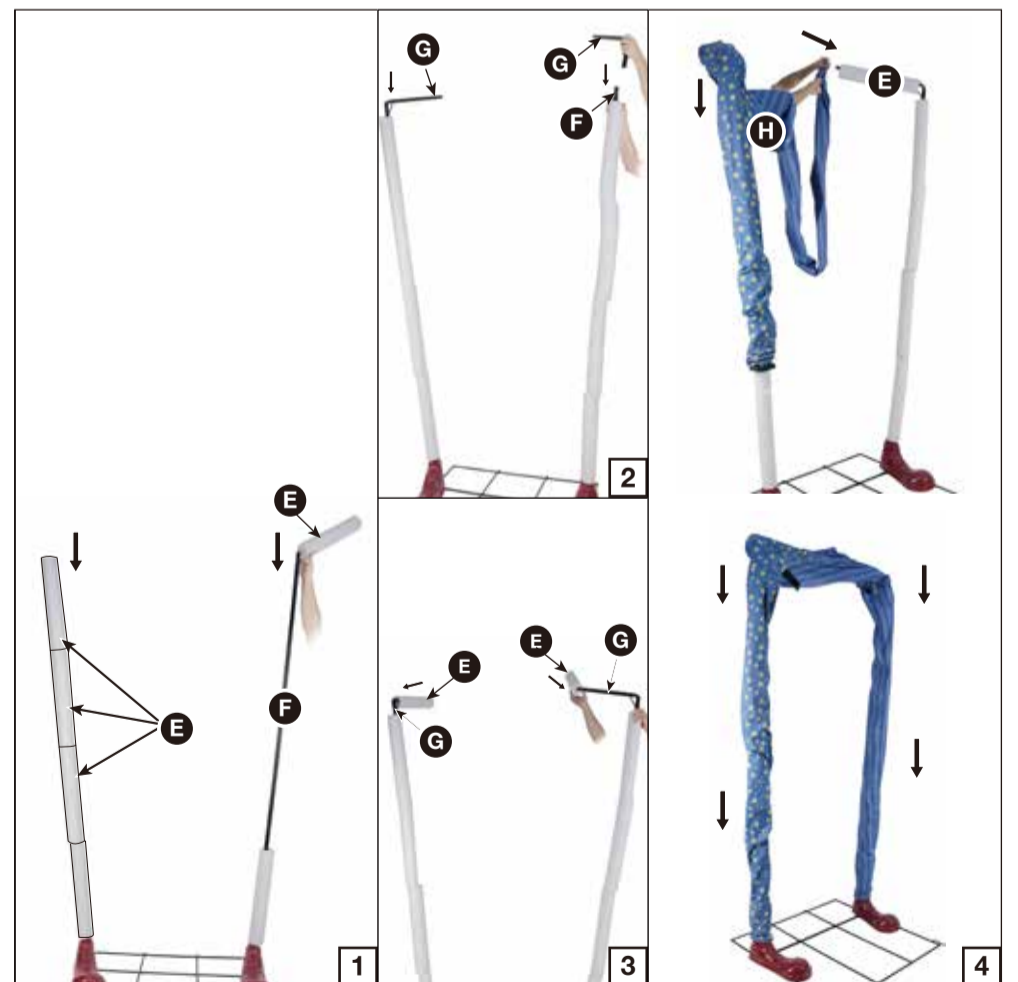

### STEP 2

Slide six (E) Foam Tubes over the (F) Middle Support Poles as shown in Figure 1.  
Attach the (G) Upper Support Poles to the (F) Middle Support Poles and secure by aligning the quick-connect push buttons into the pre-drilled holes as shown in Figure 2.  
Slide the two remaining (E) Foam Tubes over the (G) Upper Support Poles as shown in Figure 3.  
Lower the (H) Pants over the assembled (C,D,F,G) Support Poles and (E) Foam Tubes as shown in Figure 4.



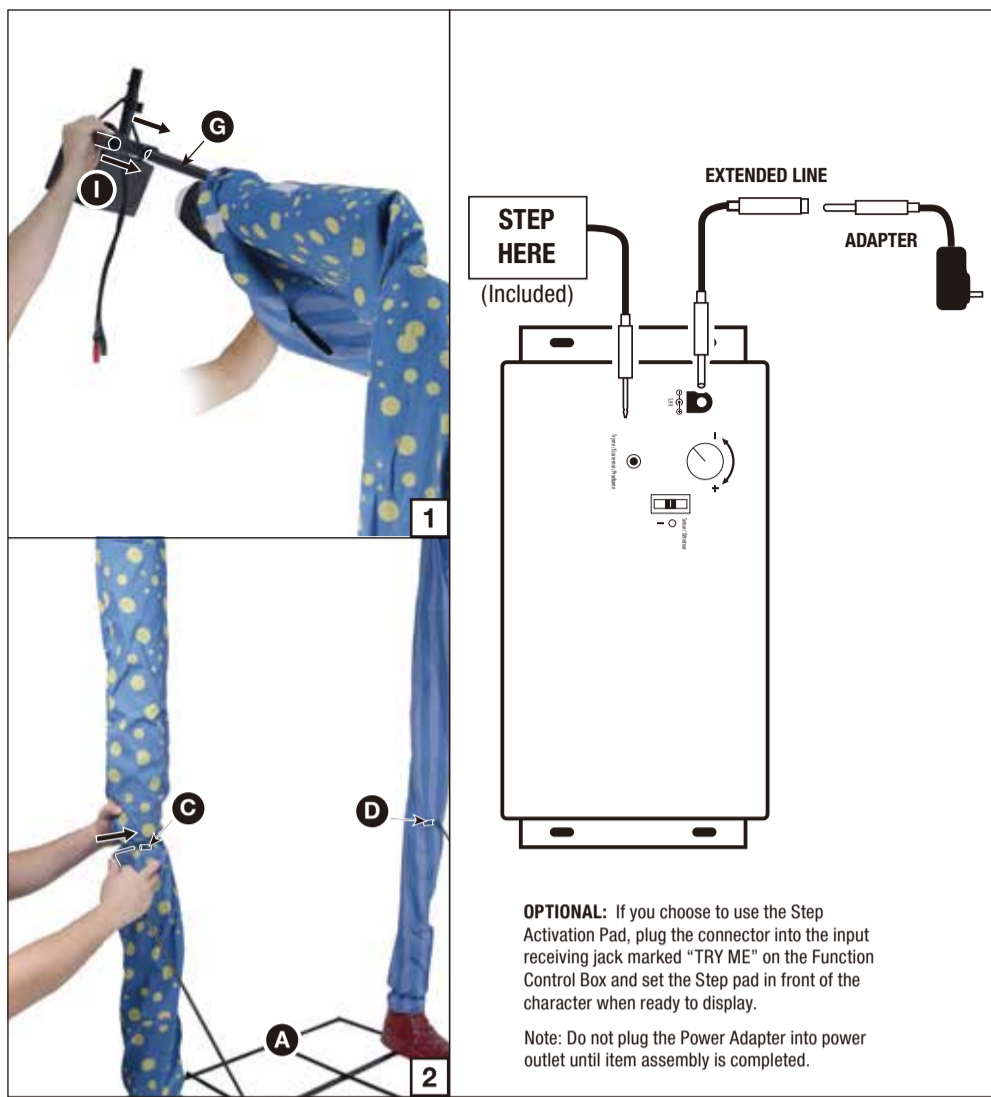

**STEP 3**

**NOTE:** The speaker on the Function Control Box located on the (H) Hip Frame should be facing front. Assemble the (H) Hip Frame onto the (F) Upper Support Poles and secure by aligning the quick-connect push buttons into the pre-drilled holes as shown in Figure 1. Slide the supports located on the (A) Base into the slots located on the (C & D) Support Poles as shown in Figure 2. Now, plug the Extended Line into the input receiving jack marked "DC 5.9V" on the Function Control Box, then plug the Adapter into the Extended Line and route the Power Adapter down and out the bottom of the item.



**STEP 4**

Lower the (J) Hip Hoop to the slots located on the (I) Hip Frame as shown in Figure 1. Pull the (H) Pants over the top of the (J) Hip Hoop and attach the (K) Torso Frame to (I) Hip Frame and secure by aligning the quick-connect push button into the pre-drilled hole as shown in Figure 2. Attach the (L) Spinal Frame onto the Shoulder Support by sliding the forked hook into the slot housing at the back of the (K) Torso Frame as shown in Figure 3. Place the (M) Costume over the (K) Torso Frame as shown in Figure 4.



**STEP 5**

Slide the (N) Right Arm up through the right sleeve and slide the forked hook into the right "shoulder" slot housing on the (K) Torso Frame as shown in Figure 1 & 2. Slide the (O) Left Arm up through the left sleeve and slide the forked hook into the left "shoulder" slot housing on the (K) Torso Frame as shown in Figure 3 & 4.

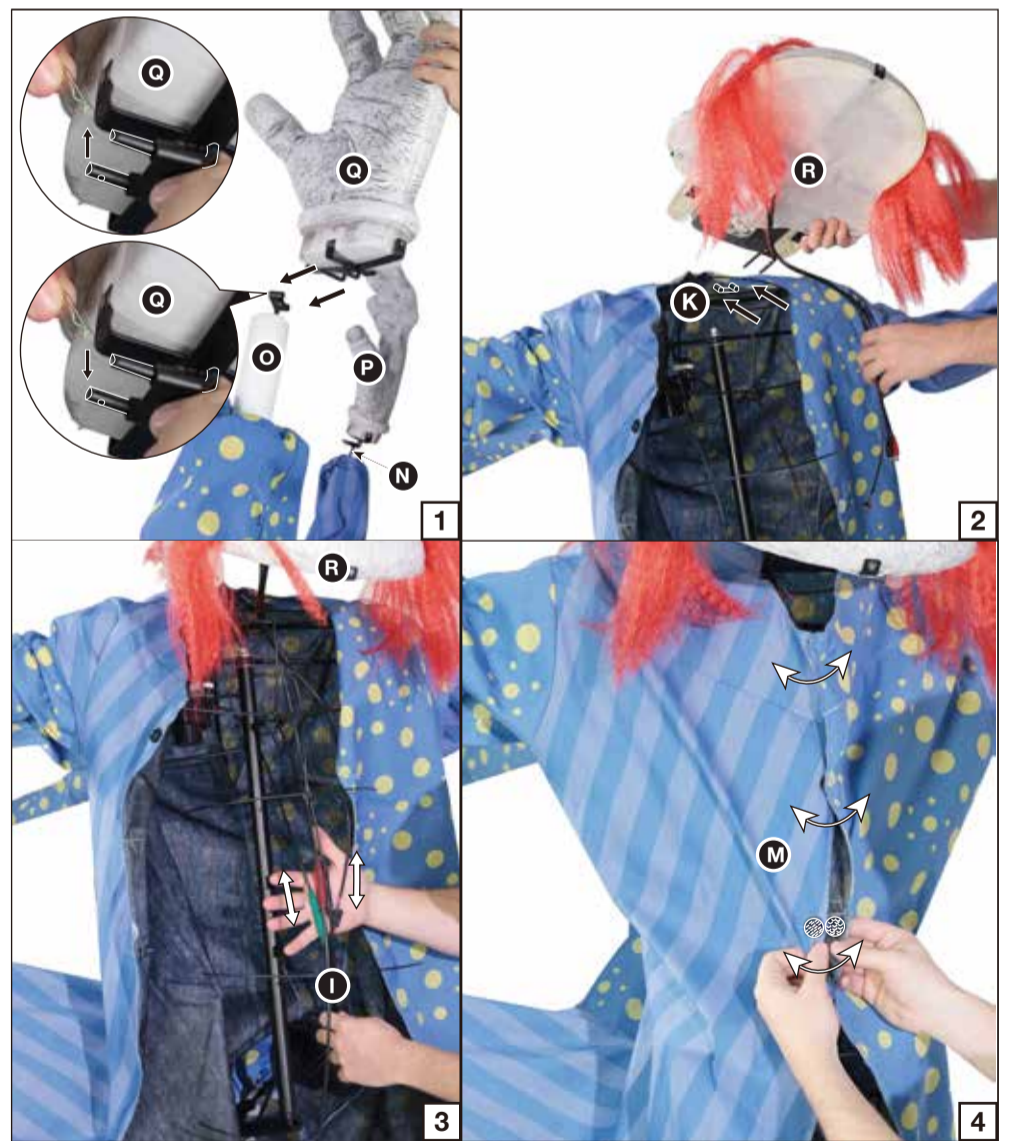

**STEP 6**

**Note:** You must pull out the pins located on the (P & Q) Hands before you connect to the (N & O) Arms. Slide the (P) Right Hand into the slot housing on the (N) Right Arm and slide the (Q) Left Hand into the slot housing on the (O) Left Arm and then slide the Pins into the slots as shown in Figure 1. Set the (R) Head onto the (K) Torso Frame by sliding the forked hook into the "neck" slot housing on the (K) Torso Frame as shown in Figure 2. Connect the cables from the (R) Head to the color-coordinated cables on the (I) Hip Frame as shown in Figure 3. Secure the back of the (M) Costume with the hook & loop closures as shown in Figure 4.





**STEP 7**

Attach the (S) Collar to the (R) Head and secure with the hook & loop closures as shown in Figure 1, 2 & 3.  
Pull the sleeves of the (M) Costume over the bottom of the (P & Q) Hands as shown in Figure 4.



**STEP 8**

Attach the (T) Door Curtain to the (H) Pants and secure with the hook & loop closures as shown in Figure 1.  
Your Looming Clown is now fully assembled. Plug in and turn on to let the fun begin!

**OPERATION INSTRUCTIONS:**

1. Plug the power adapter into a standard power outlet and adjust the settings on the Function Control Box, located on the (I) Hip Frame, as desired.

2. Settings:

**Sensor:** This switch mode will activate lights, sound, and animation when the Infra-red (IR) sensor is activated and will operate for 1 audio-cycle with each activation. The Infra-red (IR) sensor has a range of up to 2 m/6.5 ft. and will activate when someone comes within an 80-degree angle from left-to-right, as well as from above and below.

**O /OFF/Try Me:** This switch mode allows the item to be activated only if triggered by using a Step Here Try Me Activation Pad (Included). The item will operate for one audio cycle with each Try Me activation. Refer to Assembly Instructions Step3 for further details.

**I / ON :** This switch mode will continuously operate the lights, sound, and animation of the item.

**Volume Control:** Raise or lower the volume using the volume control turn dial, turn all the way down to turn the volume off.

This device complies with Part 15 of the FCC Rules. Operation is subject to the following two conditions: (1) This device may not cause harmful interference, and (2) this device must accept any interference received, including interference that may cause undesired operation.

**CAUTION:** Changes or modifications not expressly approved by the party responsible for compliance could void the user's authority to operate the equipment.

**NOTE:** This equipment has been tested and found to comply with the limits for a Class B digital device, pursuant to Part 15 of the FCC Rules. These limits are designed to provide reasonable protection against harmful interference in a residential installation. This equipment generates, uses, and can radiate radio frequency energy and, if not installed and used in accordance with the instructions, may cause harmful interference to radio communications. However, there is no guarantee that interference will not occur in a particular installation. If this equipment does cause harmful interference to radio or television reception, which can be determined by turning the equipment off and on, the user is encouraged to try to correct the interference by one or more of the following measures: Reorient or relocate the receiving antenna, Increase the separation between the equipment and receiver, Connect the equipment into an outlet on a circuit different from that to which the receiver is connected. Consult the dealer or experienced radio/TV technician for help.

