

EASY ASSEMBLY AND OPERATION INSTRUCTIONS

5124530 Clown Go-Round

This item, when assembled by the following instructions, should take 15 minutes to assemble. Please follow the step by step guide and enjoy your Clown Go-Round!

CARE AND STORAGE INSTRUCTIONS

For best performance, operate your item indoors. When not in use, store this product in its original packing. Keep away from heat and moisture.

WARNING

This item is not a toy and should be used for decoration only. This item contains small parts that can be a choking hazard. Keep all plastic and wire parts away from children.

1. Please use the adapter supplied by the manufacturer.
2. Please assemble the item according to the instructions. Connect all wires according to their matching color.
3. Children should be supervised by adults. The item should not be grabbed, as it becomes a tipping hazard. Keep away from the adapter, as it heats up during operation.

Please read all instructions carefully before assembling. Save this instruction sheet for future reference.

PARTS LIST

- A. Base
- B. Support Poles x 2
- C. Support Pole with Slots
- D. Motorbox
- E. Clown-1
- F. Clown-2
- G. Clown-3
- H. Canopy Support Poles x 3
- I. Support Pole with Canopy
- J. Step Pad

AC Adapter *

* AC Adapter Spec

Input: 100 - 240VAC 50/60Hz

Output: 5.9V 1.5A

BEFORE ASSEMBLING, REMOVE ALL THE ABOVE PARTS FROM BOX. IF ANY PART IS MISSING, DO NOT ATTEMPT TO ASSEMBLE THE PRODUCT AND CONTACT CUSTOMER SERVICE FROM 8:30AM TO 5:30PM PST AT 1-855-428-3921.

STEP 1

Attach the (B) Support Pole to the (A) Base by aligning the quick-connect push button into the pre-drilled hole as shown in Figure 1. Set the braces located on the (A) Base into the slots housings located on the (C) Support Pole with Slots. Assemble the (C) Support Pole with Slots to the (B) Support Pole by aligning the quick-connect push button into the pre-drilled hole as shown in Figure 2.

STEP 2

Attach the other (B) Support Pole to the (C) Support Pole with Slots by aligning the quick-connect push button into the pre-drilled hole as shown in Figure 1. Assemble the (D) Motorbox to the upper (B) Support Pole as shown in Figure 2. Now, plug the Adapter into the input receiving jack marked "DC 5.9V" on the Function Control Box. Note: Do not plug the Adapter into power outlet until item assembly is completed.



STEP 3
 Assemble the (E) Clown-1 to the (D) Motorbox by aligning the quick-connect push button into the pre-drilled hole as shown in Figure 1.
 Assemble the (F) Clown-2 to the (D) Motorbox by aligning the quick-connect push button into the pre-drilled hole as shown in Figure 2.

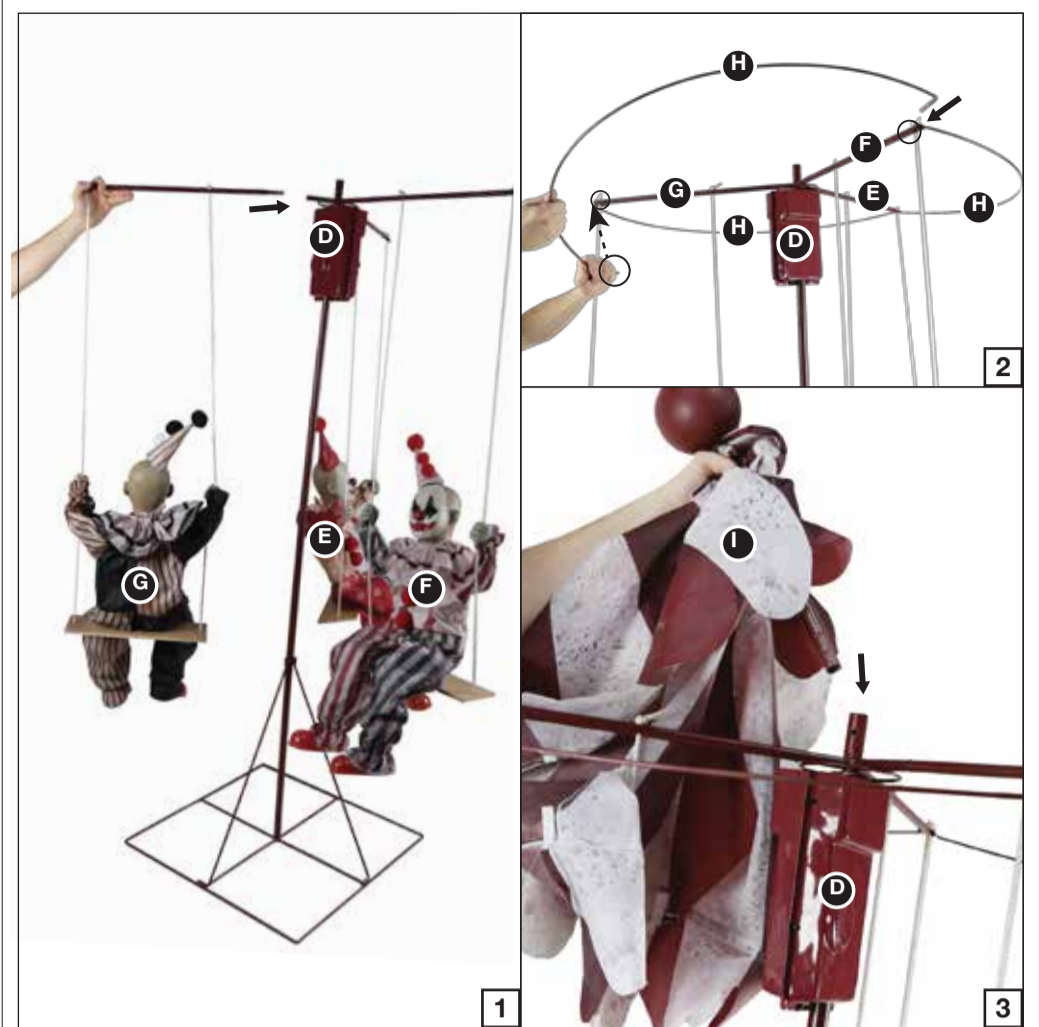

STEP 4
 Assemble the (G) Clown-3 to the (D) Motorbox by aligning the quick-connect push button into the pre-drilled hole as shown in Figure 1.
 Note: These dolls are not arranged in a certain order, you can adjust the order as you like.
 Attach the (H) Canopy Support Poles to the slot housings located on the poles from (E) Clown-1, (F) Clown-2 and (G) Clown-3 as shown in Figure 2.
 Attach the (I) Support Pole with Canopy to the (D) Motorbox by aligning the quick-connect push button into the pre-drilled hole as shown in Figure 3.



STEP 5
 Secure the (I) Support Pole with Canopy around the (H) Canopy Support Poles with the hook & loop closures as shown in Figure 1.
 Now, your Clown Go-Round is ready as shown in Figure 2.

OPERATION INSTRUCTIONS:

1. Plug the UL power adapter into a standard power outlet and adjust the settings on the Function Control Box, located on the (D) Motorbox, as desired.
2. Settings:
 On: This setting allows the item to run continuously.
 Off/Try-Me: This switch mode allows the item to be activated only if triggered by using a Step Here Try Me Activation Pad. The item will operate for one audio cycle with each Try-Me activation. Refer to Assembly Instructions Step 2 for further details.
 Sensor: This switch mode will activate lights, sound, and animation when the Infra-red (IR) sensor is activated and will operate for 1 audio-cycle with each activation. The Infra-red (IR) sensor has a range of up to 2 m/6.5 ft. and will activate when someone comes within an 80-degree angle from left-to-right, as well as from above and below.

: Raise or lower the volume using the volume control turn dial, turn and click all the way down to turn the volume off.

CAUTION: Changes or modifications not expressly approved by the party responsible for compliance could void the user's authority to operate the equipment.

NOTE: This equipment has been tested and found to comply with the limits for a Class B digital device, pursuant to Part 15 of the FCC Rules. These limits are designed to provide reasonable protection against harmful interference in a residential installation. This equipment generates, uses, and can radiate radio frequency energy and, if not installed and used in accordance with the instructions, may cause harmful interference to radio communications. However, there is no guarantee that interference will not occur in a particular installation. If this equipment does cause harmful interference to radio or television reception, which can be determined by turning the equipment off and on, the user is encouraged to try to correct the interference by one or more of the following measures; Reorient or relocate the receiving antenna. Increase the separation between the equipment and receiver. Connect the equipment into an outlet on a circuit different from that to which the receiver is connected. Consult the dealer or experienced radio/TV technician for help.

