

EASY ASSEMBLY AND OPERATION INSTRUCTIONS

5124448 Ghostly Go-Round

This item, when assembled by the following instructions, should take 15 minutes to assemble. Please follow the step by step guide and enjoy your Ghostly Go-Round!

CARE AND STORAGE INSTRUCTIONS

For best performance operate your item indoors. When not in use, store this product in its original packing. Keep away from heat and moisture.

WARNING

This item is not a toy and should be used for decoration only. This item contains small parts that can be a choking hazard. Keep all plastic and wire parts away from children.

1. Please use the transformer supplied by manufacturer.
2. Please assemble item according to instructions. Connect all wires according to matching color.
3. Children should be supervised by adults. Item should not be grabbed, as it becomes a tipping hazard. Keep all away from the transformer, as it heats up during operation.

Please read all instructions carefully before assembling. Save this instruction sheet for future reference.

PARTS LIST

- A. Base
- B. Support Poles x 2
- C. Support Pole with slots
- D. Motorbox
- E. Curly Girl
- F. Boy
- G. Pigtail Girl
- H. Step Pad



UL Adapter *
* UL Power Adapter Spec
Input: 100 - 240VAC 50/60Hz
Output: 5.9V 1.5A

BEFORE ASSEMBLING, REMOVE ALL THE ABOVE PARTS FROM BOX. IF ANY PART IS MISSING, DO NOT ATTEMPT TO ASSEMBLE THE PRODUCT AND CONTACT CUSTOMER SERVICE FROM 8:30AM TO 5:30PM PST AT 1-855-426-3321.

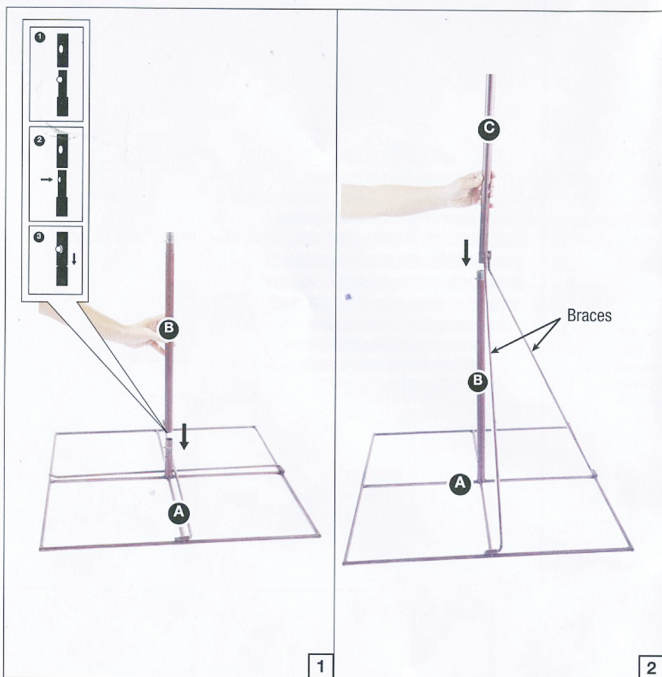

STEP 1

Attach the (B) Support Pole to the (A) Base by aligning the quick-connect push buttons into the pre-drilled holes as shown in Figure 1.
Set the braces located on the (A) Base into the slots housing located on the (C) Support Pole with slots. Assemble the (C) Support Pole with slots to the (B) Support pole by aligning the quick-connect push buttons into the pre-drilled holes as shown in Figure 2.

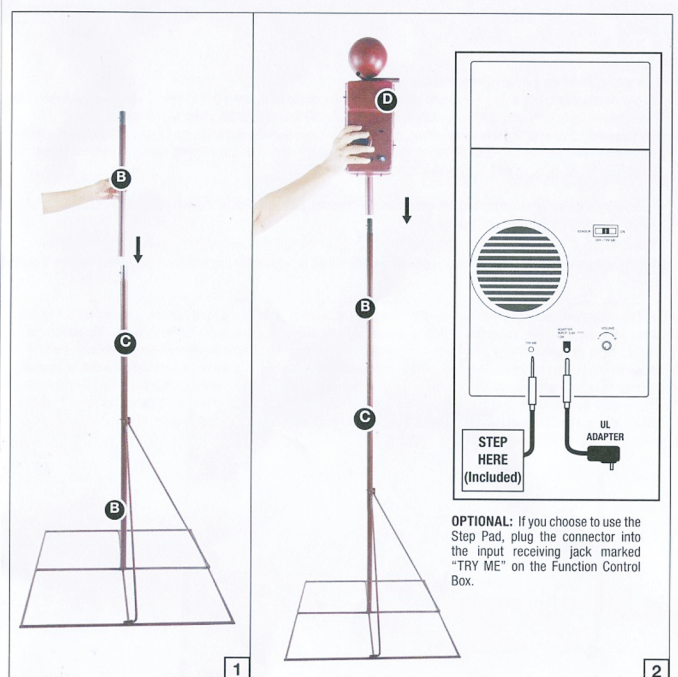

STEP 2

Attach the other (B) Support Pole to the (C) Support Pole with slots by aligning the quick-connect push buttons into the pre-drilled holes as shown in Figure 1.
Assemble the (D) Motorbox to the upper (B) Support Pole as shown in Figure 2.
Now, plug the Adapter into the input receiving jack marked "DC 5.9V" on the Function Control Box.
Note: Do not plug the Adapter into power outlet until item assembly is completed.

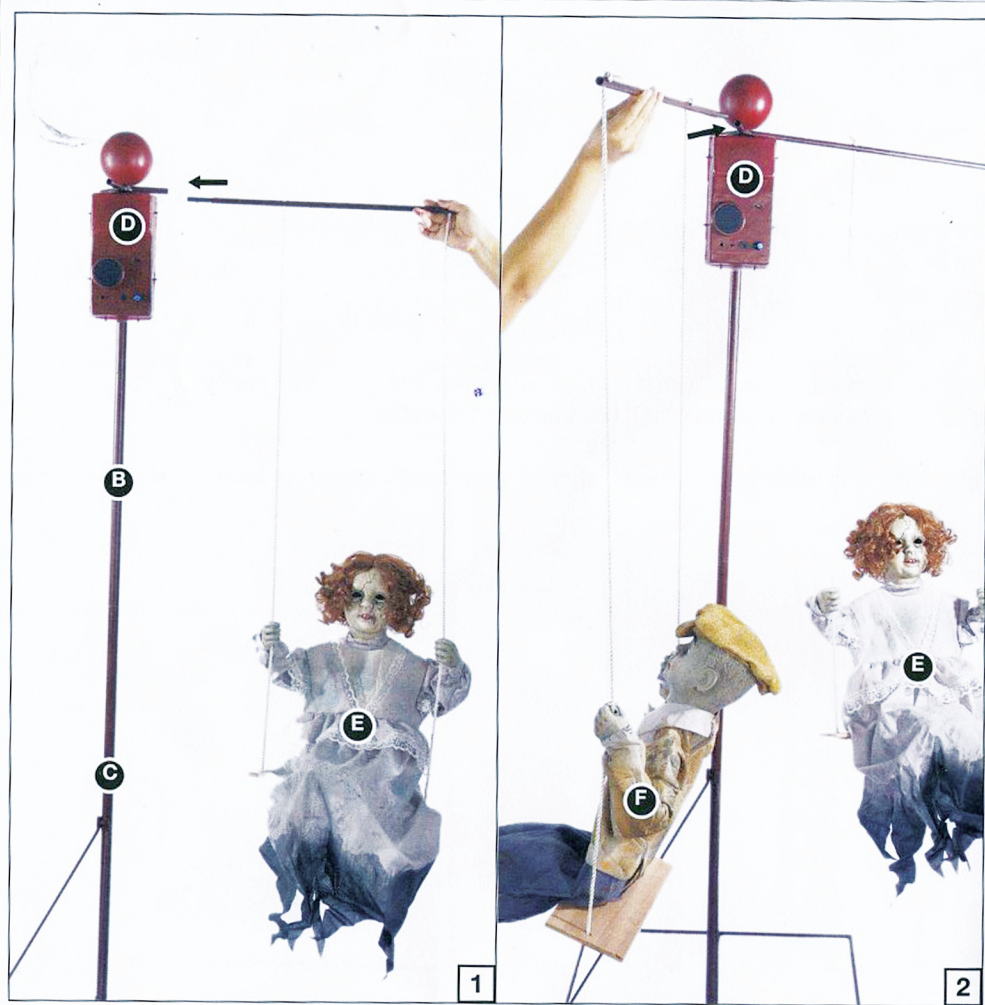

STEP 3
 Assemble the (E) Curly Girl to the (D) Motorbox by aligning the quick-connect push buttons into the pre-drilled holes as shown in Figure 1.
 Assemble the (F) Boy to the (D) Motorbox by aligning the quick-connect push buttons into the pre-drilled holes as shown in Figure 2.

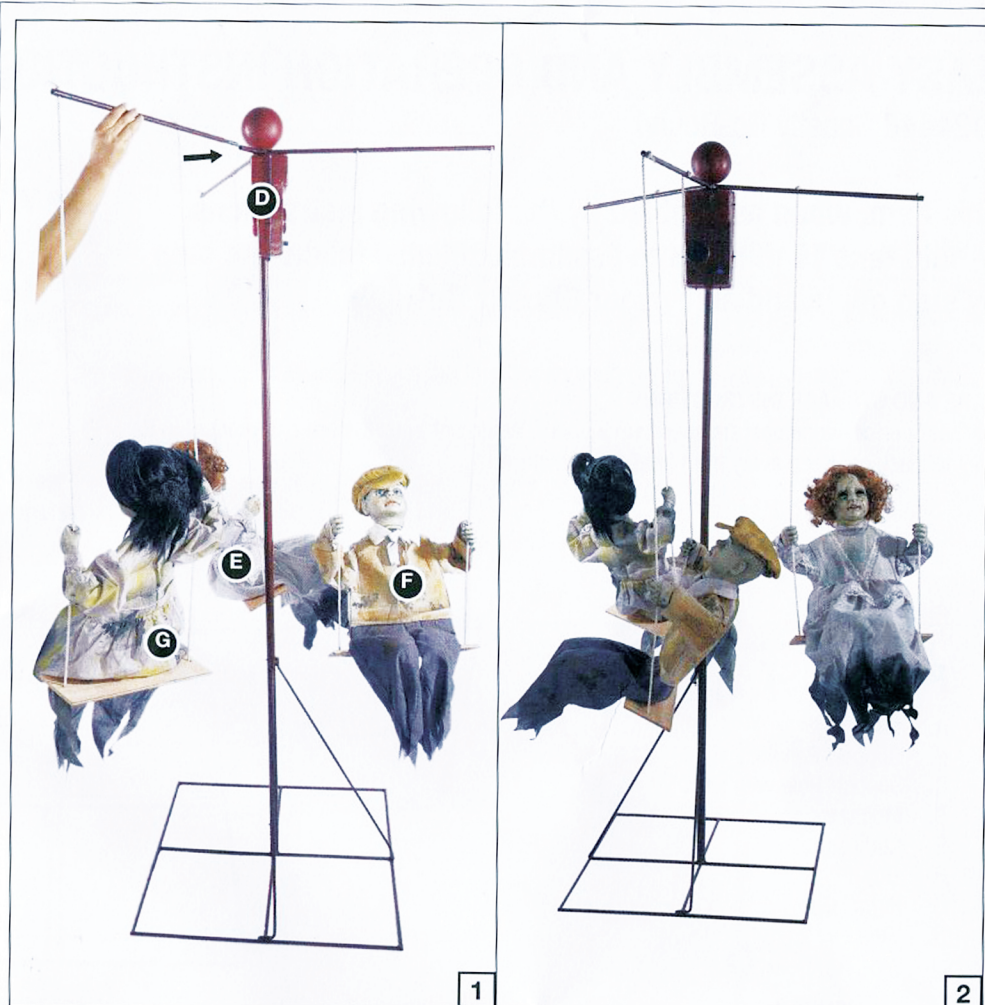

STEP 4
 Assemble the (G) Pigtail Girl to the (D) Motorbox by aligning the quick-connect push buttons into the pre-drilled holes as shown in Figure 1.
 Note: These dolls are not arranged in certain order, you can adjust the order as you like.
 Now, your Ghostly Go-Round is ready as shown in Figure 2.

OPERATION INSTRUCTIONS:

1. Plug the UL power adapter into a standard power outlet and adjust the settings on the Function Control Box, located on the (D) Motorbox, as desired.

2. Settings:
 On: This setting allows the item to run continuously.
 Off/Try-Me: This switch mode allows the item to be activated only if triggered by using a Step Here Try Me Activation Pad. The item will operate for one audio cycle with each Try-Me activation. Refer to Assembly Instructions Step 3 for further details.
 Sensor: This switch mode will activate lights, sound, and animation when the Infra-red (IR) sensor is activated and will operate for 1 audio-cycle with each activation. The Infra-red (IR) sensor has a range of up to 2 m/6.5 ft. and will activate when someone comes within an 80-degree angle from left-to-right, as well as from above and below.

: Raise or lower the volume using the volume control turn dial, turn and click all the way down to turn the volume off.

CAUTION: Changes or modifications not expressly approved by the party responsible for compliance could void the user's authority to operate the equipment.

NOTE: This equipment has been tested and found to comply with the limits for a Class B digital device, pursuant to Part 15 of the FCC Rules. These limits are designed to provide reasonable protection against harmful interference in a residential installation. This equipment generates, uses, and can radiate radio frequency energy and, if not installed and used in accordance with the instructions, may cause harmful interference to radio communications. However, there is no guarantee that interference will not occur in a particular installation. If this equipment does cause harmful interference to radio or television reception, which can be determined by turning the equipment off and on, the user is encouraged to try to correct the interference by one or more of the following measures; Reorient or relocate the receiving antenna. Increase the separation between the equipment and receiver. Connect the equipment into an outlet on a circuit different from that to which the receiver is connected. Consult the dealer or experienced radio/TV technician for help.

