

EASY ASSEMBLY AND OPERATION INSTRUCTIONS

5124445 Towering Boogeyman

This item, when assembled by the following instructions, should take 15 minutes to assemble. Please follow the step by step guide and enjoy your Towering Boogeyman!

CARE AND STORAGE INSTRUCTIONS

For best performance operate your item indoors. When not in use, store this product in its original packing. Keep away from heat and moisture.

WARNING

This item is not a toy and should be used for decoration only. This item contains small parts that can be a choking hazard. Keep all plastic and wire parts away from children.

1. Please use the adapter supplied by manufacturer.
2. Please assemble item according to instructions. Connect all wires according to matching color.
3. Children should be supervised by adults. Item should not be grabbed, as it becomes a tipping hazard. Keep all away from the adapter, as it heats up during operation.

Please read all instructions carefully before assembling. Save this instruction sheet for future reference.

PARTS LIST

- A. Base
- B. Lower Support Poles x 2
- C. Feet x 2
- D. Right Knee pole
- E. Left Knee pole
- F. Long Foam Tubes x 2
- G. Right Hip pole
- H. Left Hip pole
- I. Short Foam Tubes x 2
- J. Pants
- K. Torso Frame
- L. Hip Hoop
- M. Shoulder Support
- N. Coat
- O. Spine
- P. Chest
- Q. Head
- R. Right Arm
- S. Left Arm with Child
- T. Hood
- U. Step Pad

UL Power Adapter *
 * UL Power Adapter Spec
 Input: 100 - 240VAC 50/60Hz
 Output: 5.9V 2A

BEFORE ASSEMBLING, REMOVE ALL THE ABOVE PARTS FROM BOX. IF ANY PART IS MISSING, DO NOT ATTEMPT TO ASSEMBLE THE PRODUCT AND CONTACT CUSTOMER SERVICE FROM 8:30AM TO 5:30PM PST AT 1-855-428-3921.

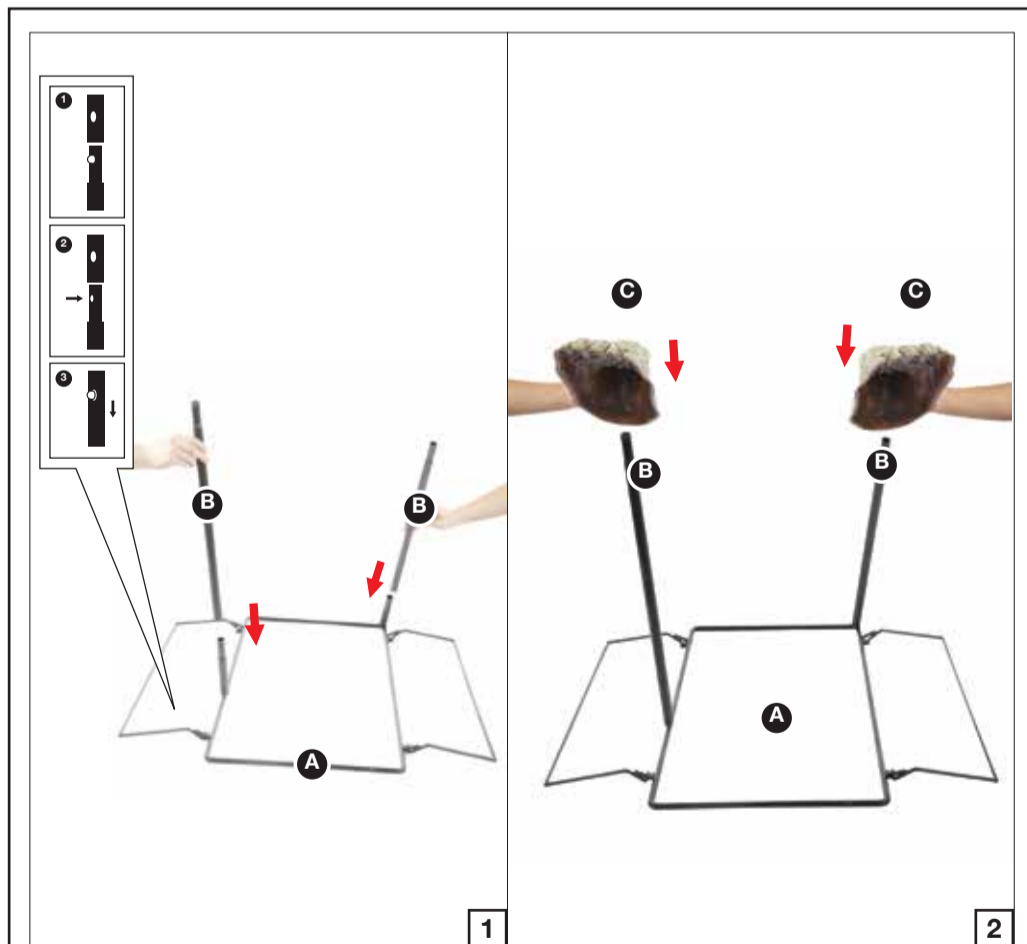

STEP1

Note: The posts located on the (A) Base angle towards the front.
 Attach the (B) Lower Support Poles to the (A) Base as shown and secure by aligning the quick-connect push button into the pre-drilled holes as shown in Figure 1.
 Lower (C) feet over the (B) Lower Support Poles as shown in Figure 2.

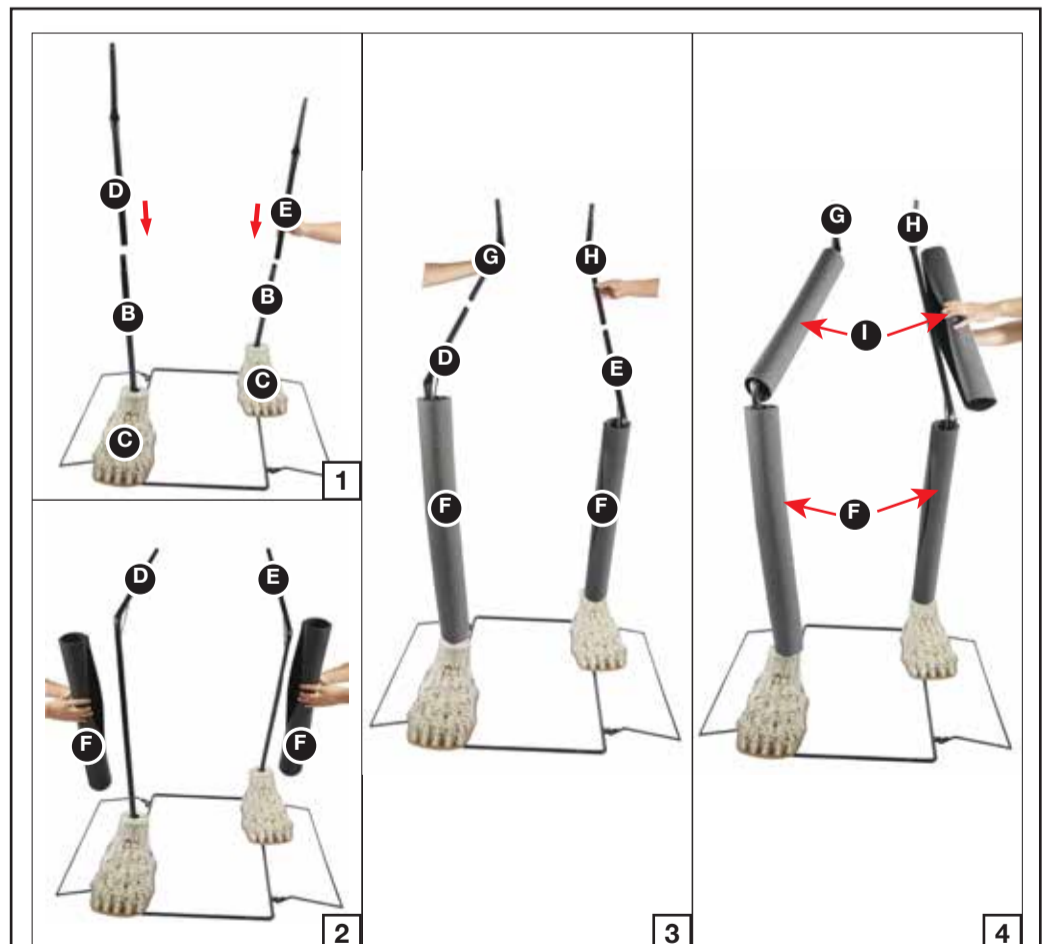

STEP2

Attach the (D) & (E) Knee Poles to the (B) Lower Support Poles, and secure by aligning the quick connect push button into the pre-drilled holes as shown in Figure 1.
 Wrap the (B) Lower Support poles and (D) & (E) Knee Poles with the (F) Long Foam Tubes as shown in Figure 2.
 Attach the (G) & (H) Hip Poles to the (D) & (E) Knee Poles, and secure by aligning the quick connect push button into the pre-drilled holes as shown in Figure 3.
 Wrap the (G) & (H) Hip Poles and (D) & (E) Knee Poles with the (I) Short Foam Tubes as shown in Figure 4.

STEP3

NOTE: The speaker on the Function Control Box located on the (K) Torso Frame should be facing front.

Lower the (J) Pants over the assembling support poles as shown in Figure 1.

Assemble the (K) Torso Frame onto the (G) & (H) Hip Poles, and secure by aligning the quick-connect push buttons into the pre-drilled holes as shown in Figure 2.

Now, plug the Adapter into the input receiving jack marked "DC 5.9V" on the Function Control Box and route the UL Power Adapter down and out the bottom of the item.

Note: Do not plug the Adapter into power outlet until item assembly is completed.

OPTIONAL: If you choose to use the Step Here Try-Me Activation Pad, plug the connector into the input receiving jack marked "TRY ME" on the Function Control Box and set the Step Pad in front of the character when ready to display.

STEP4

Lower the (L) Hip Hoop down over the (K) Torso Frame and attach through the slots located on the bottom of the (K) Torso Frame as shown in Figure 1. Pull the (J) Pants up over the (L) Hip Hoop as shown in Figure 2.

Attach the (M) Shoulder Frame into the slots located on the top of the (K) Torso Frame as shown in Figure 3. Set the hook attached on the (M) Shoulder Frame on the ring located on the middle of the (K) Torso Frame as shown in Figure 4.

STEP5

Lower the (N) Coat down over the (M) Shoulder Support & (K) Torso Frame as shown in Figure 1.

Attach the (O) Spine onto the (M) Shoulder Support by sliding the forked hook into the slot housing at the back of the (M) Shoulder Support as shown in Figure 2.

Slide the sensor cable fixed on the (P) Chest through the hole located on the front of the (N) Coat, Set the (P) Chest through the hole into the slot housing at the front of the (M) Shoulder Support as shown in Figure 3.

Set the (Q) Head onto (K) Torso Frame by sliding the forked hook into the "neck" slot housing on the (K) Torso Frame as shown in Figure 4.

STEP6

Slide the (R) Right Arm up through the right sleeve and slide the forked hook into the right "shoulder" slot housing on the (M) Shoulder Frame as shown in Figure 1.

Slide the (S) Left Arm with Child up through the left sleeve and slide the forked hook into the left "shoulder" slot housing on the (M) Shoulder Frame as shown in Figure 2.

Secure the hook & loop closures at both wrists as shown in Figures 3. & 4.

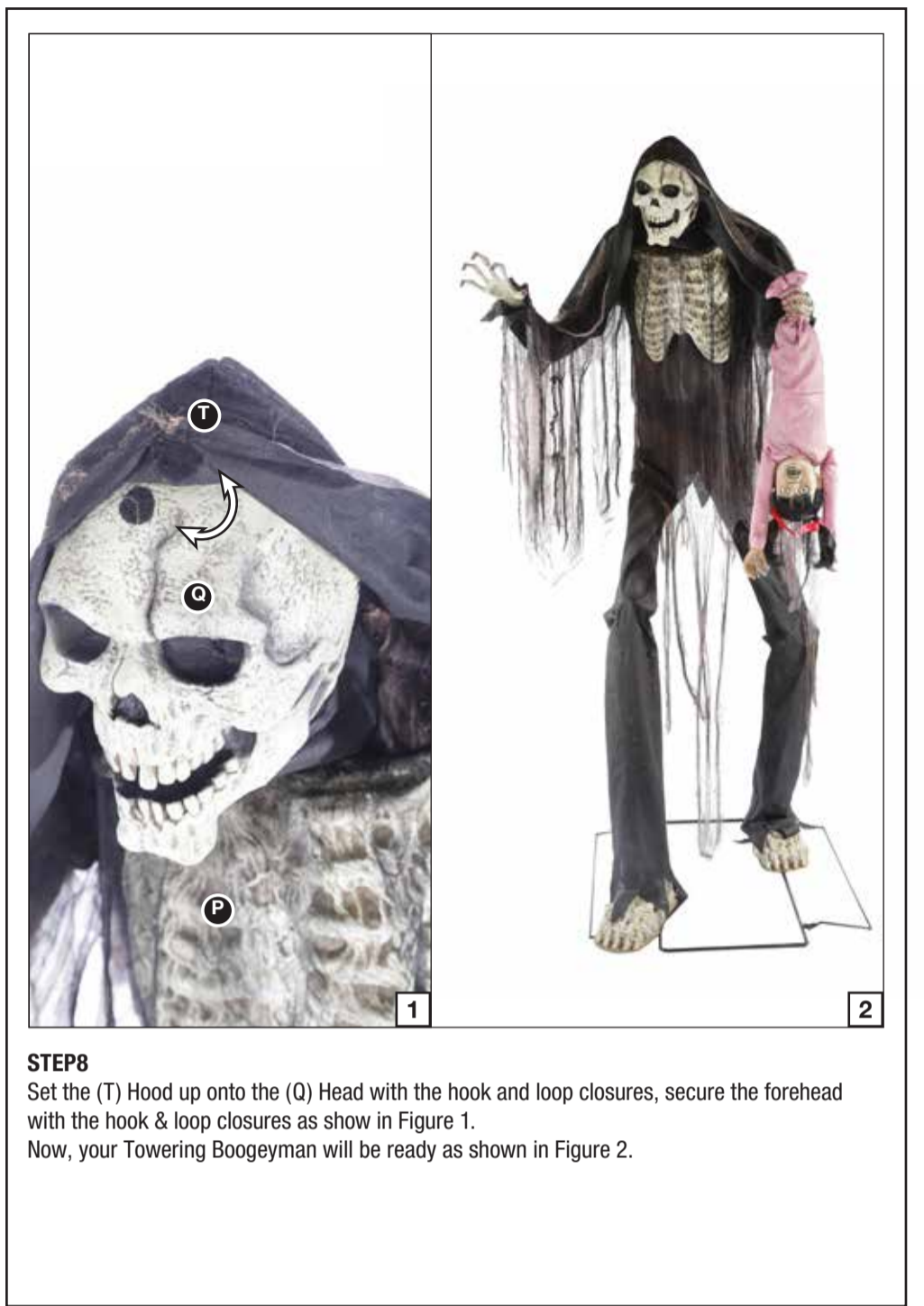
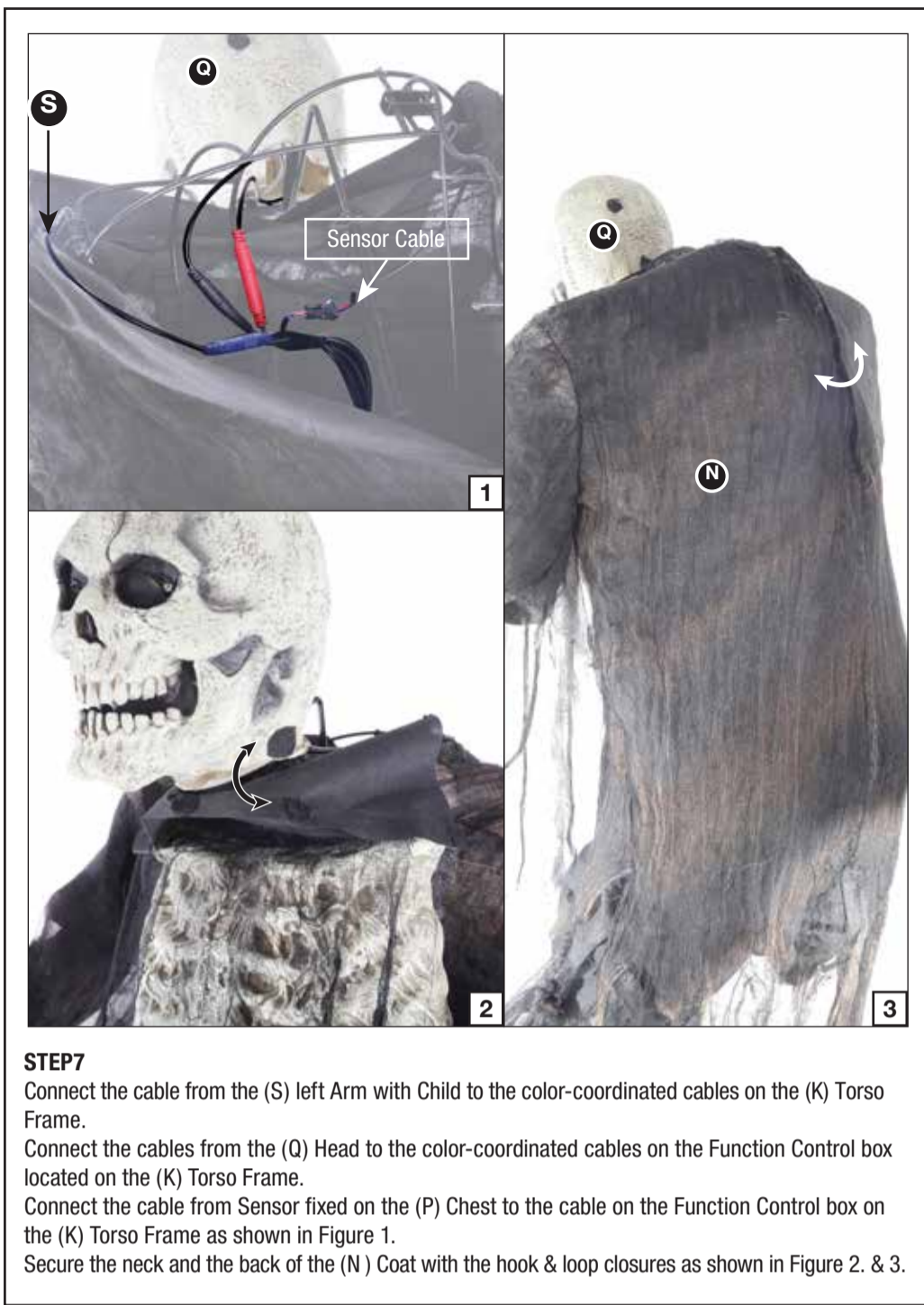

OPERATION INSTRUCTIONS:

1. Plug the UL power adapter into a standard power outlet and adjust the settings on the Function Control Box, located on the (K) Torso Frame, as desired.

2. Settings:

Sensor: This switch mode will activate lights, sound, and animation when the Infra-red (IR) sensor is activated and will operate for 1 audio-cycle with each activation. The Infra-red (IR) sensor has a range of up to 2 m/6.5 ft. and will activate when someone comes within an 80-degree angle from left-to-right, as well as from above and below.

○ / OFF / Try Me: This switch mode allows the item to be activated only if triggered by using a Step Here Try Me Activation Pad. The item will operate for one audio cycle with each Try Me activation. Refer to Assembly Instructions Step3 for further details.

I / ON : This switch mode will continuously operate the lights, sound, and animation of the item.

🔊: Raise or lower the volume using the volume control turn dial, turn and click all the way down to turn the volume off.

CAUTION: Changes or modifications not expressly approved by the party responsible for compliance could void the user's authority to operate the equipment.

NOTE: This equipment has been tested and found to comply with the limits for a Class B digital device, pursuant to Part 15 of the FCC Rules. These limits are designed to provide reasonable protection against harmful interference in a residential installation. This equipment generates, uses, and can radiate radio frequency energy and, if not installed and used in accordance with the instructions, may cause harmful interference to radio communications. However, there is no guarantee that interference will not occur in a particular installation. If this equipment does cause harmful interference to radio or television reception, which can be determined by turning the equipment off and on, the user is encouraged to try to correct the interference by one or more of the following measures: Reorient or relocate the receiving antenna, Increase the separation between the equipment and receiver, Connect the equipment into an outlet on a circuit different from that to which the receiver is connected. Consult the dealer or experienced radio/TV technician for help.

