

14352619 Bobble Head Leprechaun Craft Kit

Instructions:

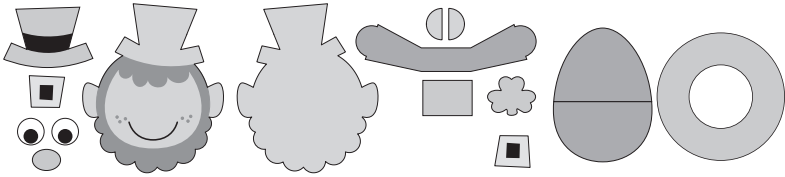

1. Open the plastic egg and thread the chenille stem through one bottom and one top hole.

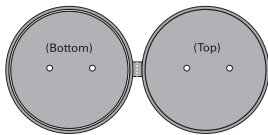

2. Coil chenille stem. Leave a 1-2" tail to attach head pieces.
Bend to secure

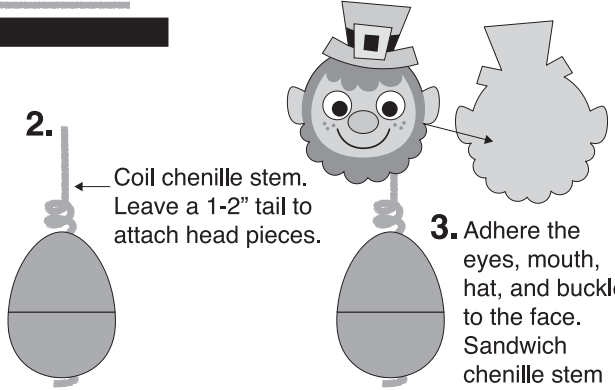

3. Adhere the eyes, mouth, hat, and buckle to the face. Sandwich chenille stem between the head pieces.

4. Adhere the shamrock, belt, and buckle to the egg.

5. Adhere the hands to the front of the arms. Use the rectangle to adhere the arms to the back of the egg.

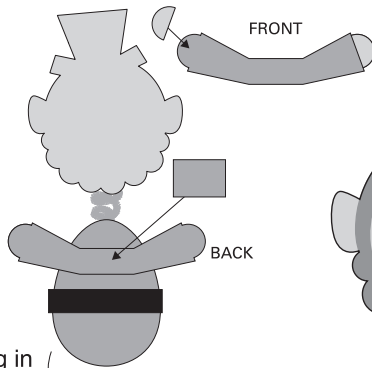

Set egg in foam base.

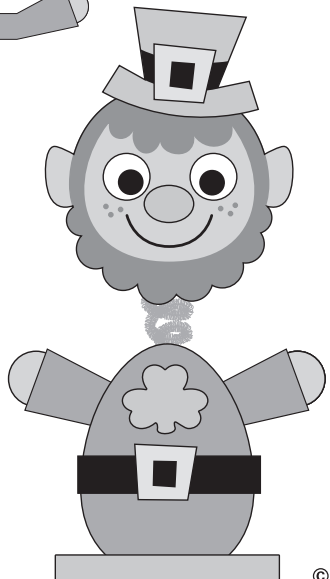

© OTC