

# TIGHTROPE<sup>TM</sup>

## RULES

### CONTENTS:



4 Marble cups



24 Pegs



20 Stretchy silicone bands

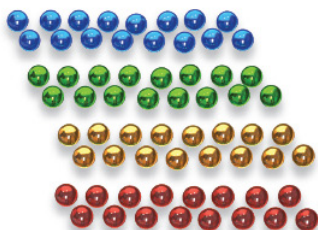

64 Small marbles



4 Big marbles

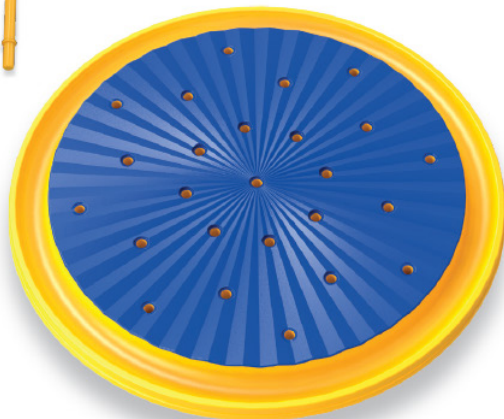

1 Game board

**WARNING:**  
**CHOKING HAZARD—**

Toy contains marbles.  
Not for children under 3 yrs.



2-4 Players



6+



20 Minutes



MindWare®

## **OBJECT:**

Be the first to balance all your marbles on the high wire stretchy bands.

## **SET UP:**

Each player takes 5 pegs and 3 stretchy bands. Starting with the youngest player, everyone takes turns placing their pegs randomly into the board.

(If there are three players, take 6 pegs and 4 bands each; if two players, take 7 pegs and 5 bands each.)

Moving clockwise, everyone stretches their bands around three or more pegs, creating a web suspended over the board. Place them strategically, without leaving large gaps.

Finally, each player takes all the marbles of one color into their cup.

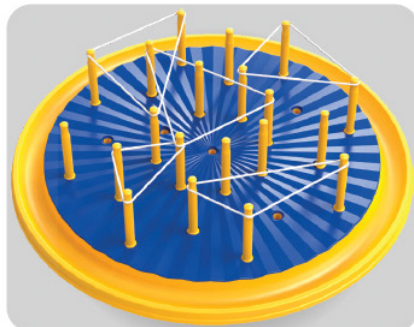
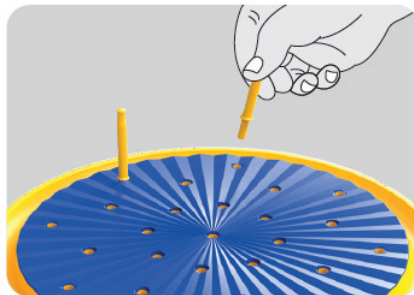

## ***GAME PLAY:***

On their turn, each player balances one marble onto the stretchy bands. Marbles may be placed anywhere on the web, such as against pegs, against other marbles, or even on top of other marbles.

Large marbles can be placed at any time, but they should be used strategically to fill gaps too large for the smaller marbles.

On their turn, if a player drops a marble or causes other marbles to fall off, they must take those marbles into their cup and play them on future turns-even if the marbles are not their color.

If a big marble is knocked off, it is returned to the box and can't be played again.

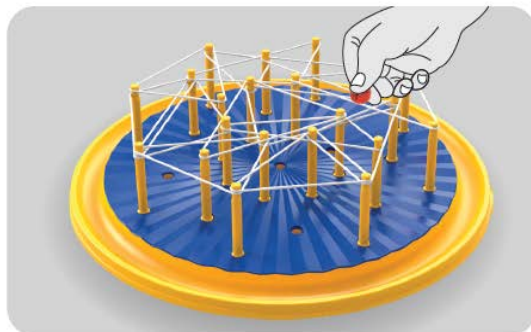



**The first player to place all their marbles is the winner! Any remaining players will finish the round, and if anyone else also places their last marble on the last turn, the game is officially a tie.**



**Note: If a player thinks there are no safe spots to put a marble, they can pass their turn. If all players pass, the game is over, and the player with the fewest remaining marbles wins.**



**A different game every time you play!**

# ***MORE WAYS TO PLAY***

## ***FINISHING BIG***

Played the same as a typical game of Tightrope, except you must use your big marble last.

## ***HIGH SCORE***

Keep track of points to add another level of strategy! Add 1 point for each marble placed, subtract 1 point for each marble knocked off. Total up the points at the end to see who was the Tightrope champion!

## ***WATCH HOW TO PLAY***

Scan here with your phone to watch a short video introduction to the Tightrope rules!



**CHECK OUT OTHER GREAT GAMES AT MINDWARE.COM!**

Over  
5 Million  
Sold!



Logic  
Game  
for  
1 Player!



SCAN TO CHECK  
OUT ALL THE GAMES!



MINDWARE.COM

Share your game  
nights with us!



#MindWaretoys

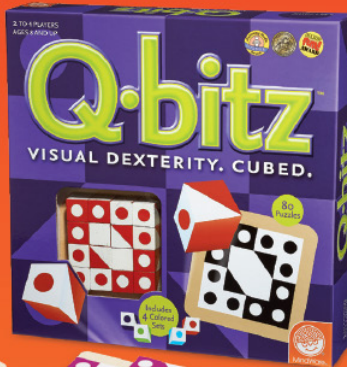

 **MindWare**  
® brainy toys for kids of all ages®

for other MindWare products visit  
[www.mindware.com](http://www.mindware.com)

© 2023 MindWare®  
2140 West County Road C  
Roseville, MN 55113  
Ph 800.274.6123

UK Authorised Representative:  
IQS Ltd, Enterprise House  
West Park, Silsoe  
Bedfordshire, MK45 4HR  
UK

EU Authorised Representative:  
Vulcan, The Merrion Buildings  
18-20 Merrion Street Upper  
Dublin 2, D02 XH98  
Ireland

[international@mwwholesale.biz](mailto:international@mwwholesale.biz)

Patent Pending



Warning: Small parts.  
Not for children  
under 3 years.

UK  
CA CE

Keep all relevant  
information.