

13970872 Tropical Wreath Craft Kit

Instructions:

Layer leaves onto the white base using a glue gun (not included).

Using the picture as a guide, assemble the flowers as shown using the double-sided adhesive foam squares.

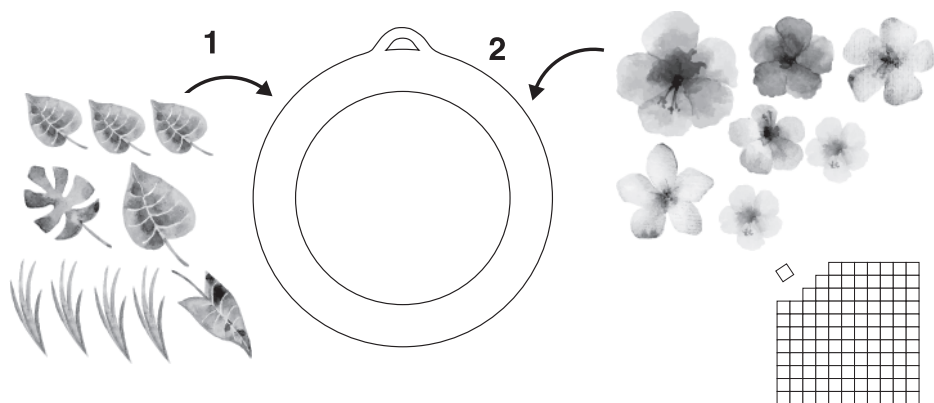

© OTC



Share your fun!

Tag your photo with **#orientaltrading** on Instagram or upload your photos at **orientaltrading.com/sharefun**.