

13963706 Dr. Seuss Directional Sign

PLEASE READ INSTRUCTIONS BEFORE YOU BEGIN

- Check that all materials are included in your kit.
- Make sure that your work area is large enough to assemble the item.
- Assembly time should be about 30 minutes for two people.

COMPONENT LIST

QTY. 1	A) SIGN POST
QTY. 3	B) POST SUPPORT
QTY. 1	C-1) SIGN BASE
QTY. 1	C-2) SIGN
QTY. 1	C-3) SIGN
QTY. 1	C-4) SIGN
QTY. 1	C-5) SIGN
QTY. 1	C-6) SIGN
QTY. 1	C-7) SIGN
QTY. 1	C-8) SIGN
QTY. 1	C-9) SIGN
QTY. 1	C-10) SIGN TOPPER
QTY. 20	D) PLASTIC PLUGS

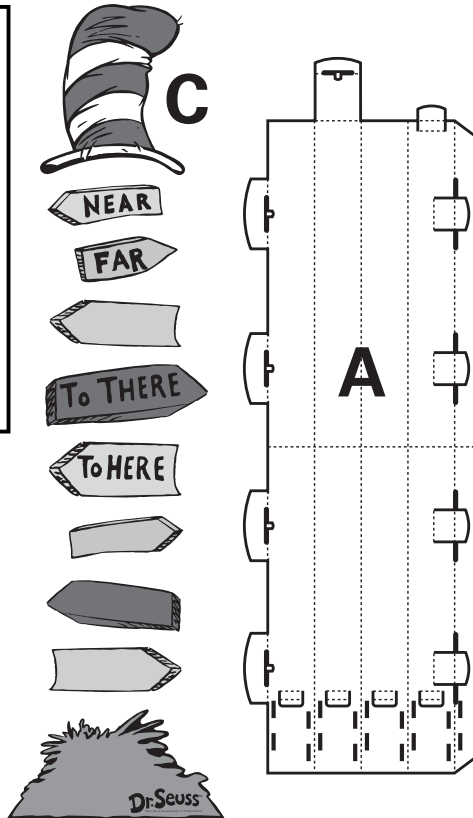
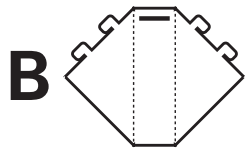

STEP 1:

Fold piece A into a box shape and secure the tabs.

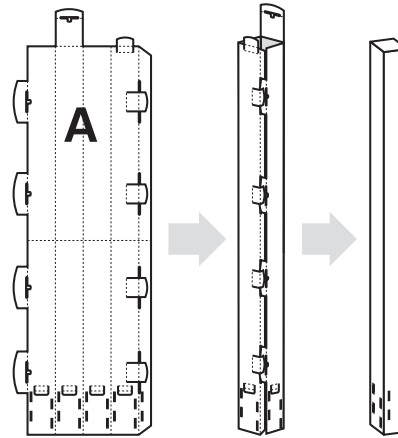

STEP 2:

Fold the sides of B to create a triangular box shape as shown. Lift the flap on A and insert the tabs of B into the four slots on one side of A. To secure, insert the flap into the top slit on B.

Repeat with other B pieces.

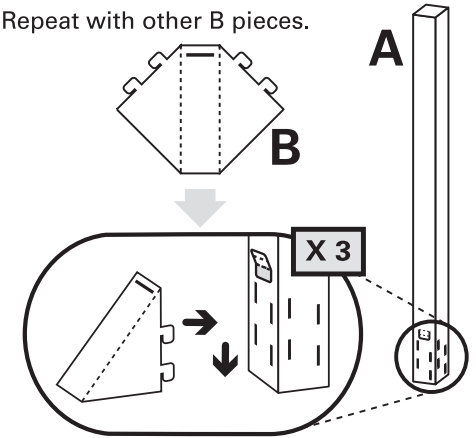

STEP 3:

Use two D pieces to attach one C piece to A starting at the bottom.

Repeat until all C pieces are attached.

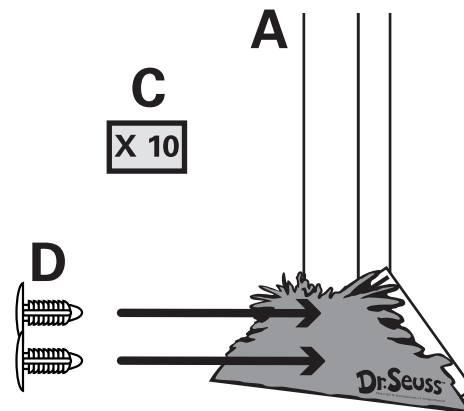

Your Directional Sign is finished!

Have fun with your new directional sign! Use it as a display piece or as part of a scene.



WARNING!!!
THE DIRECTIONAL SIGN IS NOT CAPABLE OF SUSTAINING HEAVY WEIGHTS.

HELPFUL TIPS:

- When folding the pieces make sure the print is facing outward.
- Follow the diagram below to insert and close the tab openings.



Share your fun!

Tag your photo with **#orientaltrading** on Instagram or upload your photos at **orientaltrading.com/sharefun**.