

Lantern Assembly Instructions

©2017 Oriental Trading Company, Inc.
OrientalTrading.com (800)228-2269

STEP 1

Open the lantern by holding the wire at the top and the bottom and pulling gently.

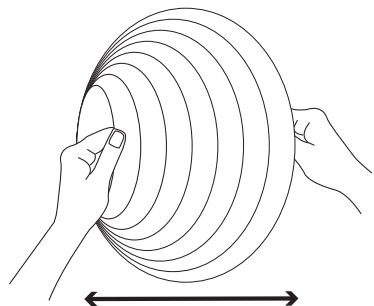

STEP 2

To secure the lantern open, insert the wire frame into the bottom of the lantern and pull the lantern up over the wire frame. Insert the top of the wire frame into the wire tabs on the top of the lantern, being careful to avoid tearing.

(Please note: the wire frame will bend slightly.)

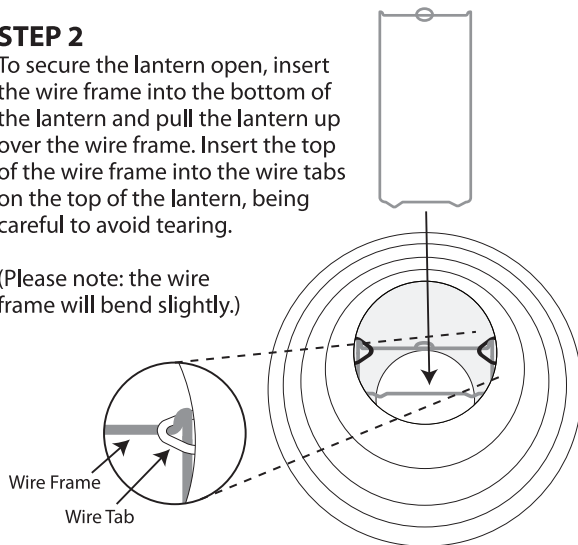

STEP 3

Attach a string (not included) to the wire loop in the center of the wire frame.

Hang where desired.



STEP 4

Adhere the accent pieces to the corresponding lantern as shown.

